

Plastic housings

TAKE UP UNIT TPL

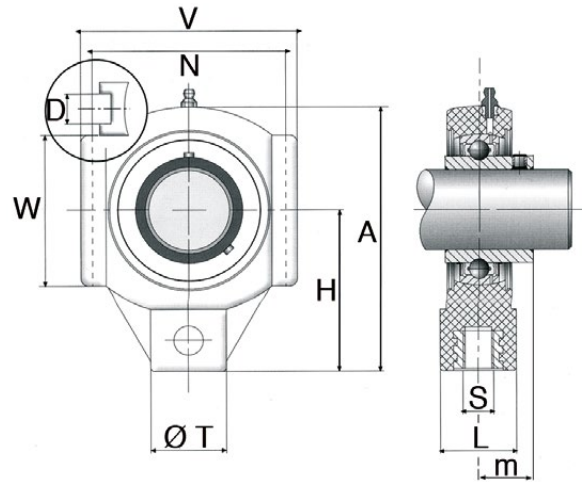
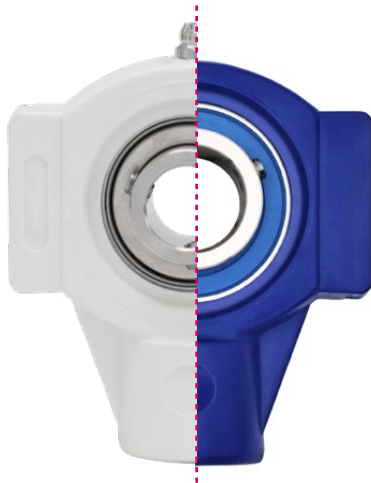

TYPE	Ø SHAFT (H7)*	DIMENSIONS									WEIGHT (MUC)
		mm	A	D	H	L	N	S	T	V	

● ○ ● TPL204	20	99	12	64,0	27,5	76,2	M16	36	89	47	0,33
● ○ ● TPL205	25	99	12	64,0	27,5	76,0	M16	36	89	47	0,36
● ○ ● TPL206	30	125	12	76,2	34,5	89,0	M16	40	103	63	0,63
○ ● TPL207	35	125	12	76,2	34,5	89,0	M16	40	103	63	0,75
○ ● TPL208	40	140	16	85,0	34,5	102,0	M16	40	113	80	0,93
○ ● TPL209	45	149	16	90,0	40,0	102,0	M20	50	117	85	1,02
○ ● TPL210	50	149	16	90,0	40,0	102,0	M20	50	117	85	1,18

* recommended shaft tolerance field: g

TENSILE DIRECTION	BREAKING FORCE (NEWTON)						
	201-4	205	206	207	208	209	210
	14800	15500	15800	16500	17300	18210	18860
	3930	4530	5100	6500	7800	8710	9750
	8500	10350	10900	11300	12150	12900	13550
	40770	45300	46100	44100	42800	44230	44880



*A shaft seal can only be configured in combination with a **blue housing** and **MB bearing insert**.



VARIATIONS/ACCESSORIES

Material Housing:	✓ Plastic PBT (polybutylene terephthalate)
Bearing inserts:	✓ MB Stainless Steel ✓ MBG Stainless Steel ✓ MUC Stainless Steel ✓ B Steel ✓ PNS Plastic
Housing colours:	● blue without grease nipple ○ white ● black
Accessories:	✓ Open protective cap ✓ Closed protective cap ● Shaft seal blue/black*