

## FRN 400\*

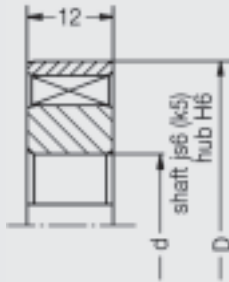

without bearing support

## FN 400

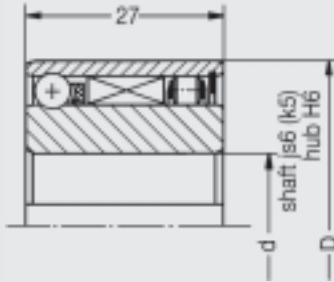

with bearing

## FND 400 ◆ ○

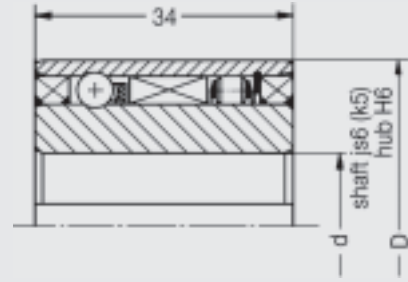
with bearing  
and double seal

Dimensions [mm] [inch]		FRN 400*	FN 400	FND400◆	Torque M		Idling speed $n_{max}$ [RPM]	Load Capacities [N]			
d	D	Part number			[ftlb]	[Nm]		C dynamic [lb]		C <sub>0</sub> static	
							Ball	Roller	Ball	Roller	
10 .3937	31 1.2205	FRN 427 FRN 427 Z			59 49	80 66	4 400				
					86 71	116 97					
12 .4724	36 1.4173	FRN 432 FRN 432 Z					3 700				
15 .5906	41 1.6142	FRN 437 FRN 437 Z	FN 437 FN 437 Z	FND 437 FND 437 Z+	117 101	158 137	3 200 ○ (1 700)	7 325 1 646	7 400 1 663	3 870 870	6 920 1 555
20 .7874	46 1.8110	FRN 442 FRN 442 Z	FN 442 FN 442 Z+	FND 442 + FND 442 Z	152 131	207 178	2 800 ○ (1 500)	7 980 1 793	8 410 1 890	4 570 1 027	8 560 1 924
25 .9843	58 2.2835	FRN 453 FRN 453 Z	FN 453 + FN 453 Z	FND 453 FND 453 Z	246 207	333 281	2 200 ○ (1 200)	8 690 1 953	9 460 2 126	5 640 1 267	10 860 2 441
30 1.1811	64 2.5197	FRN 459 FRN 459 Z	FN 459 + FN 459 Z	FND 459 FND 459 Z	305 263	414 357	2 000 ○ (1 100)	8 805 1 979	10 560 2 373	6 010 1 351	13 050 2 933
35 1.3780	68 2.6772	FRN 463 FRN 463 Z			348 300	472 407	1 900				
40 1.5748	75 2.9528	FRN 470 FRN 470 Z	FN 470 + FN 470 Z	FND 470 FND 470 Z	429 370	583 502	1 700 ○ (1 000)	9 645 2 168	11 690 2 627	7 405 1 664	15 870 3 566
45 1.7717	78 3.0709	FRN 473 FRN 473 Z			467 402	633 545	1 600				

The load capacities "C" and "C<sub>0</sub>" are not valid for the FRN 400 series!

Maximum radial clearance for the FRN 400 series pending application 0.02 mm.

\* Torque capacity stated is valid for the clutch but not for the keyway!

Keyway specifications according to DIN 6885 Bl. 1 (P9) with back clearance (connecting dimensions on page 22).

+ Different bore sizes available on request

◆ Arrow on inner ring shows: idling direction of outer ring = locking direction of inner ring

○ Idling speed for series FND

Other sizes on request.  
Dimensions subject to change.

10 Nm ≈ 1 kpm; 10 N ≈ 1 kp