

# CSK-2RS Kugellagerfreilauf / One-way Clutch Bearing

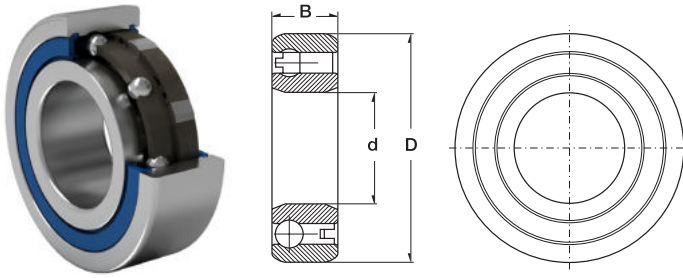

3

Dimension (mm)			Designation/Type	Series	* Load Rating		Resistent torque $T_R$ (Ncm)	$T_{KM}$ (Nm)	Weight (g) approx.
d	D	B			C, dyn. kN	C, stat. kN			
12.0	32.0	14.0	CSK12-2RS	-	6.1	2.77	3.00	7.40	50 g
15.0	35.0	16.0	CSK15-2RS	-	7.4	3.42	4.00	13.50	70 g
17.0	40.0	17.0	CSK17-2RS	-	7.9	3.8	5.60	24.50	90 g
20.0	47.0	19.0	CSK20-2RS	-	9.4	4.46	6.00	40.00	145 g
25.0	52.0	20.0	CSK25-2RS	-	10.7	5.46	6.00	68.00	175 g
30.0	62.0	21.0	CSK30-2RS	-	11.7	6.45	7.50	110.00	270 g
35.0	72.0	22.0	CSK35-2RS	-	12.6	7.28	8.20	140.00	400 g
40.0	80.0	27.0	CSK40-2RS	-	15.54	12.25	10.00	260.00	600 g

# CSK-P Kugellagerfreilauf / One-way Clutch Bearing

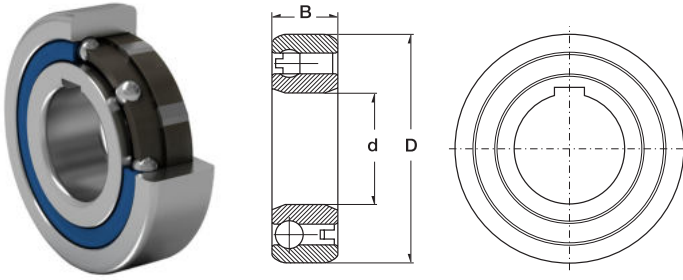

4

Dimension (mm)			Designation/Type	Series	* Load Rating		Resistent torque $T_R$ (Ncm)	$T_{KM}$ (Nm)	Weight (g) approx.
d	D	B			C, dyn. kN	C, stat. kN			
15.0	35.0	11.0	CSK15-P	6202	7.4	3.42	0.90	13.50	60 g
17.0	40.0	12.0	CSK17-P	6203	7.9	3.8	1.10	24.50	70 g
20.0	47.0	14.0	CSK20-P	6204	9.4	4.46	1.30	40.00	110 g
25.0	52.0	15.0	CSK25-P	6205	10.7	5.46	2.00	68.00	110 g
30.0	62.0	15.0	CSK30-P	6206	11.7	6.45	4.40	110.00	210 g
35.0	72.0	17.0	CSK35-P	6207	12.6	7.28	5.80	140.00	300 g
40.0	80.0	22.0	CSK40-P	-	15.54	12.25	7.00	260.00	500 g

## CSK-PP Kugellagerfreilauf / One-way Clutch Bearing

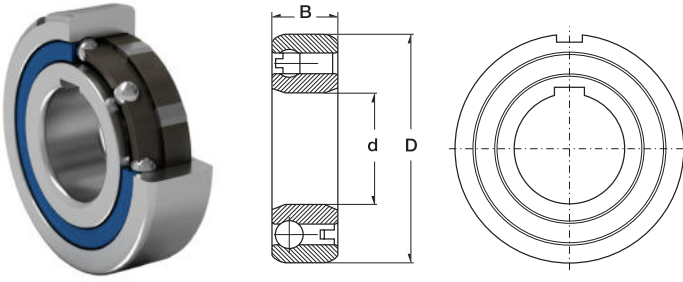

5

Dimension (mm)			Designation/Type	Series	* Load Rating		Resistent torque $T_R$ (Ncm)	$T_{KM}$ (Nm)	Weight (g) approx.
d	D	B			C, dyn. kN	C, stat. kN			
15.0	35.0	11.0	CSK15-PP	6202	7.4	3.42	0.90	13.50	60 g
17.0	40.0	12.0	CSK17-PP	6203	7.9	3.8	1.10	24.50	70 g
20.0	47.0	14.0	CSK20-PP	6204	9.4	4.46	1.30	40.00	110 g
25.0	52.0	15.0	CSK25-PP	6205	10.7	5.46	2.00	68.00	140 g
30.0	62.0	16.0	CSK30-PP	6206	11.7	6.45	4.40	110.00	210 g
35.0	72.0	17.0	CSK35-PP	6207	12.6	7.28	5.80	140.00	300 g
40.0	80.0	22.0	CSK40-PP	-	15.54	12.25	7.00	260.00	500 g