

# SNR BU CATALOGUE 2-BOLT FLANGED UNITS

## Remarks

Bearing inserts use different versions of set screws.

**NTN bearing inserts:** UC200 / AS200: ball point type  
UEL200: Cup point type (eccentric locking collar)

**SNR bearing inserts:** UC200 / US200 / EX200: knurled cup point type

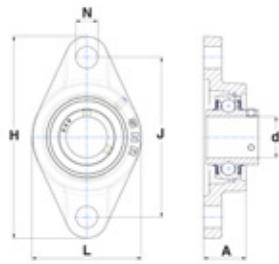

UCFL200

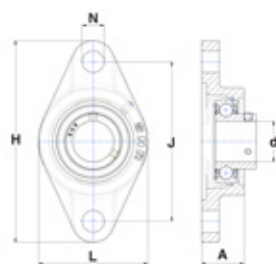

USFL200

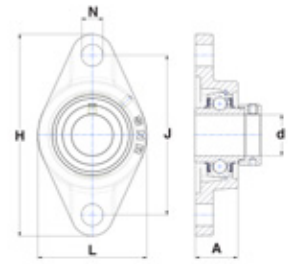

EXFL200

NTN corresponding Part Number	SNR BRAND									
	SNR Part Number Bearing Unit	SNR Part Number Housing	SNR Part Number Bearing	Bore diameter (d in mm)	Housing length (H in mm)	Mounting hole distance (J in mm)	Housing height (A in mm)	Housing width (L in mm)	Mounting bore Ø (N in mm)	Weight (kg)
UCFL204-012D1	UCFL204-12	FL204	UC204-12G2	19,05	113	90	25,5	60	12	0,47
UCFL204D1	UCFL204	FL204	UC204G2	20	113	90	25,5	60	12	0,47
UCFL205-014D1	UCFL205-14	FL205	UC205-14G2	22,225	130	99	27	68	16	0,61
UCFL205-015D1	UCFL205-15	FL205	UC205-15G2	23,813	130	99	27	68	16	0,61
UCFL205-100D1	UCFL205-16	FL205	UC205-16G2	25,4	130	99	27	68	16	0,60
UCFL205D1	UCFL205	FL205	UC205G2	25	130	99	27	68	16	0,61
UCFL206-102D1	UCFL206-18	FL206	UC206-18G2	28,575	148	117	31	80	16	0,94
UCFL206-103D1	UCFL206-19	FL206	UC206-19G2	30,163	148	117	31	80	16	0,91
UCFL206-104D1	UCFL206-20	FL206	UC206-20G2	31,75	148	117	31	80	16	0,90
UCFL206D1	UCFL206	FL206	UC206G2	30	148	117	31	80	16	0,92
UCFL207-104D1	UCFL207-20	FL207	UC207-20G2	31,75	161	130	34	90	16	1,23
UCFL207-105D1	UCFL207-21	FL207	UC207-21G2	33,338	161	130	34	90	16	1,21
UCFL207-106D1	UCFL207-22	FL207	UC207-22G2	34,925	161	130	34	90	16	1,18
UCFL207-107D1	UCFL207-23	FL207	UC207-23G2	36,513	161	130	34	90	16	1,15
UCFL207D1	UCFL207	FL207	UC207G2	35	161	130	34	90	16	1,17
UCFL208-108D1	UCFL208-24	FL208	UC208-24G2	38,1	175	144	36	100	16	1,58
UCFL208-109D1	UCFL208-25	FL208	UC208-25G2	39,688	175	144	36	100	16	1,55
UCFL208D1	UCFL208	FL208	UC208G2	40	175	144	36	100	16	1,54
UCFL209-110D1	UCFL209-26	FL209	UC209-26G2	41,275	188	148	38	108	19	1,98
UCFL209-111D1	UCFL209-27	FL209	UC209-27G2	42,863	188	148	38	108	19	1,94
UCFL209-112D1	UCFL209-28	FL209	UC209-28G2	44,45	188	148	38	108	19	1,90
UCFL209D1	UCFL209	FL209	UC209G2	45	188	148	38	108	19	1,88
UCFL210-114D1	UCFL210-30	FL210	UC210-30G2	47,625	197	157	40	115	19	2,27
UCFL210-115D1	UCFL210-31	FL210	UC210-31G2	49,213	197	157	40	115	19	2,22
UCFL210D1	UCFL210	FL210	UC210G2	50	197	157	40	115	19	2,20
UCFL211-200D1	UCFL211-32	FL211	UC211-32G2	50,8	224	184	43	130	19	3,17
UCFL211-202D1	UCFL211-34	FL211	UC211-34G2	53,975	224	184	43	130	19	3,07
UCFL211-203D1	UCFL211-35	FL211	UC211-35G2	55,563	224	184	43	130	19	3,00
UCFL211D1	UCFL211	FL211	UC211G2	55	224	184	43	130	19	3,02
UCFL212-204D1	UCFL212-36	FL212	UC212-36G2	57,15	250	202	48	140	23	3,97
UCFL212-206D1	UCFL212-38	FL212	UC212-38G2	60,325	250	202	48	140	23	3,83
UCFL212-207D1	UCFL212-39	FL212	UC212-39G2	61,913	250	202	48	140	23	3,75
UCFL212D1	UCFL212	FL212	UC212G2	60	250	202	48	140	23	3,83

# SNR BU CATALOGUE 2-BOLT FLANGED UNITS

## Remarks

Bearing inserts use different versions of set screws.

**NTN bearing inserts:** UC200 / AS200: ball point type  
UEL200: Cup point type (eccentric locking collar)

**SNR bearing inserts:** UC200 / US200 / EX200: knurled cup point type

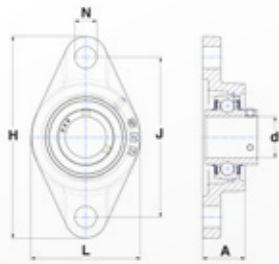

UCFL200

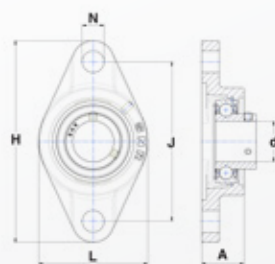

USFL200

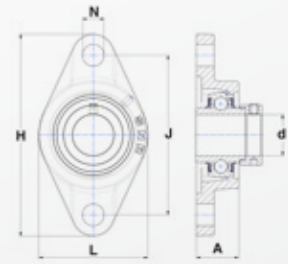

EXFL200

NTN corresponding Part Number	SNR BRAND									
	SNR Part Number Bearing Unit	SNR Part Number Housing	SNR Part Number Bearing	Bore diameter (d in mm)	Housing length (H in mm)	Mounting hole distance (J in mm)	Housing height (A in mm)	Housing width (L in mm)	Mounting bore Ø (N in mm)	Weight (kg)
UELFL204-012D1W3	EXFL204-12	FL204	EX204-12G2	19,05	113	90	25,5	60	12	0,52
UELFL204D1W3	EXFL204	FL204	EX204G2	20	113	90	25,5	60	12	0,52
UELFL205-014D1W3	EXFL205-14	FL205	EX205-14G2	22,225	130	99	27	68	16	0,65
UELFL205-015D1W3	EXFL205-15	FL205	EX205-15G2	23,813	130	99	27	68	16	0,65
UELFL205-100D1W3	EXFL205-16	FL205	EX205-16G2	25,4	130	99	27	68	16	0,64
UELFL205D1W3	EXFL205	FL205	EX205G2	25	130	99	27	68	16	0,65
UELFL206-102D1W3	EXFL206-18	FL206	EX206-18G2	28,575	148	117	31	80	16	1,03
UELFL206-103D1W3	EXFL206-19	FL206	EX206-19G2	30,163	148	117	31	80	16	1,00
UELFL206-104D1W3	EXFL206-20	FL206	EX206-20G2	31,75	148	117	31	80	16	0,98
UELFL206D1W3	EXFL206	FL206	EX206G2	30	148	117	31	80	16	1,01
UELFL207-104D1W3	EXFL207-20	FL207	EX207-20G2	31,75	161	130	34	90	16	1,36
UELFL207-105D1W3	EXFL207-21	FL207	EX207-21G2	33,338	161	130	34	90	16	1,34
UELFL207-106D1W3	EXFL207-22	FL207	EX207-22G2	34,925	161	130	34	90	16	1,31
UELFL207-107D1W3	EXFL207-23	FL207	EX207-23G2	36,513	161	130	34	90	16	1,28
UELFL207D1W3	EXFL207	FL207	EX207G2	35	161	130	34	90	16	1,30
UELFL208-108D1W3	EXFL208-24	FL208	EX208-24G2	38,1	175	144	36	100	16	1,73
UELFL208-109D1W3	EXFL208-25	FL208	EX208-25G2	39,688	175	144	36	100	16	1,72
UELFL208D1W3	EXFL208	FL208	EX208G2	40	175	144	36	100	16	1,68
UELFL209-110D1W3	EXFL209-26	FL209	EX209-26G2	41,275	188	148	38	108	19	2,16
UELFL209-111D1W3	EXFL209-27	FL209	EX209-27G2	42,863	188	148	38	108	19	2,11
UELFL209-112D1W3	EXFL209-28	FL209	EX209-28G2	44,45	188	148	38	108	19	2,07
UELFL209D1W3	EXFL209	FL209	EX209G2	45	188	148	38	108	19	2,07
UELFL210-114D1W3	EXFL210-30	FL210	EX210-30G2	47,625	197	157	40	115	19	2,50
UELFL210-115D1W3	EXFL210-31	FL210	EX210-31G2	49,213	197	157	40	115	19	2,44
UELFL210D1W3	EXFL210	FL210	EX210G2	50	197	157	40	115	19	2,41
UELFL211-200D1W3	EXFL211-32	FL211	EX211-32G2	50,8	224	184	43	130	19	3,48
UELFL211-202D1W3	EXFL211-34	FL211	EX211-34G2	53,975	224	184	43	130	19	3,28
UELFL211-203D1W3	EXFL211-35	FL211	EX211-35G2	55,563	224	184	43	130	19	3,26
UELFL211D1W3	EXFL211	FL211	EX211G2	55	224	184	43	130	19	3,29
UELFL212-204D1W3	EXFL212-36	FL212	EX212-36G2	57,15	250	202	48	140	23	4,33
UELFL212-206D1W3	EXFL212-38	FL212	EX212-38G2	60,325	250	202	48	140	23	4,10
UELFL212-207D1W3	EXFL212-39	FL212	EX212-39G2	61,913	250	202	48	140	23	4,06
UELFL212D1W3	EXFL212	FL212	EX212G2	60	250	202	48	140	23	4,17

NTN corresponding Part Number	SNR BRAND									
	SNR Part Number Bearing Unit	SNR Part Number Housing	SNR Part Number Bearing	Bore diameter (d in mm)	Housing length (H in mm)	Mounting hole distance (J in mm)	Housing height (A in mm)	Housing width (L in mm)	Mounting bore Ø (N in mm)	Weight (kg)
ASFL204-012D1	USFL204-12	FL204	US204-12G2	19,05	113	90	25,5	60	12	0,43
ASFL204D1	USFL204	FL204	US204G2	20	113	90	25,5	60	12	0,43
ASFL205-014D1	USFL205-14	FL205	US205-14G2	22,225	130	99	27	68	16	0,58
ASFL205-015D1	USFL205-15	FL205	US205-15G2	23,813	130	99	27	68	16	0,58
ASFL205-100D1	USFL205-16	FL205	US205-16G2	25,4	130	99	27	68	16	0,56
ASFL205D1	USFL205	FL205	US205G2	25	130	99	27	68	16	0,57
ASFL206-102D1	USFL206-18	FL206	US206-18G2	28,575	148	117	31	80	16	0,88
ASFL206-103D1	USFL206-19	FL206	US206-19G2	30,163	148	117	31	80	16	0,85
ASFL206-104D1	USFL206-20	FL206	US206-20G2	31,75	148	117	31	80	16	0,84
ASFL206D1	USFL206	FL206	US206G2	30	148	117	31	80	16	0,87
ASFL207-106D1	USFL207-22	FL207	US207-22G2	34,925	161	130	34	90	16	1,08
ASFL207-107D1	USFL207-23	FL207	US207-23G2	36,513	161	130	34	90	16	1,07
ASFL207D1	USFL207	FL207	US207G2	35	161	130	34	90	16	1,12
ASFL208-108D1	USFL208-24	FL208	US208-24G2	38,1	175	144	36	100	16	1,50
ASFL208D1	USFL208	FL208	US208G2	40	175	144	36	100	16	1,50
ASFL209-110D1	USFL209-26	FL209	US209-26G2	41,275	188	148	38	108	19	1,95
ASFL209-111D1	USFL209-27	FL209	US209-27G2	42,863	188	148	38	108	19	1,92
ASFL209-112D1	USFL209-28	FL209	US209-28G2	44,45	188	148	38	108	19	1,87
ASFL209D1	USFL209	FL209	US209G2	45	188	148	38	108	19	1,85
ASFL210-114D1	USFL210-30	FL210	US210-30G2	47,625	197	157	40	115	19	2,20
ASFL210-115D1	USFL210-31	FL210	US210-31G2	49,213	197	157	40	115	19	2,18
ASFL210D1	USFL210	FL210	US210G2	50	197	157	40	115	19	2,16
-	USFL211-32	FL211	US211-32G2	50,8	224	184	43	130	19	3,00
-	USFL211-35	FL211	US211-35G2	55,563	224	184	43	130	19	2,95
-	USFL211	FL211	US211G2	55	224	184	43	130	19	2,97
-	USFL212-36	FL212	US212-36G2	57,15	250	202	48	140	23	3,60
-	USFL212-39	FL212	US212-39G2	61,913	250	202	48	140	23	3,52
-	USFL212	FL212	US212G2	60	250	202	48	140	23	3,60