

SNR BU CATALOGUE 4-BOLT FLANGED UNITS

Remarks

Bearing inserts use different versions of set screws.

NTN bearing inserts: UC200 / AS200: ball point type
UEL200: Cup point type (eccentric locking collar)

SNR bearing inserts: UC200 / US200 / EX200: knurled cup point type

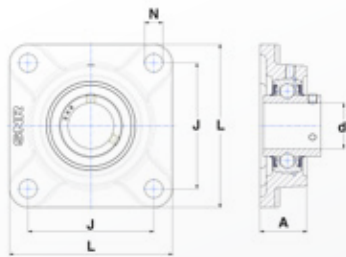

UCFP200

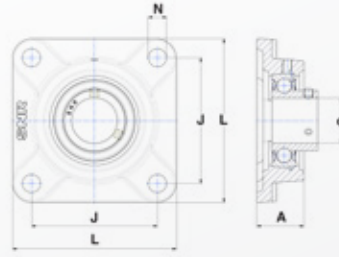

USFP200

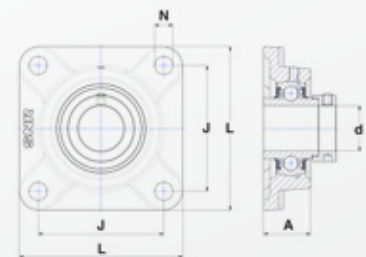

EXF200

NTN corresponding Part Number	SNR BRAND								
	SNR Part Number Bearing Unit	SNR Part Number Housing	SNR Part Number Bearing	Bore diameter (d in mm)	Housing length (L in mm)	Mounting hole distance (J in mm)	Housing height (A in mm)	Mounting bore Ø (N in mm)	Weight (kg)
UCF204-012D1	UCF204-12	F204	UC204-12G2	19,05	86	64	25,5	12	0,57
UCF204D1	UCF204	F204	UC204G2	20	86	64	25,5	12	0,57
UCF205-014D1	UCF205-14	F205	UC205-14G2	22,225	95	70	27	12	0,81
UCF205-015D1	UCF205-15	F205	UC205-15G2	23,813	95	70	27	12	0,81
UCF205-100D1	UCF205-16	F205	UC205-16G2	25,4	95	70	27	12	0,80
UCF205D1	UCF205	F205	UC205G2	25	95	70	27	12	0,81
UCF206-102D1	UCF206-18	F206	UC206-18G2	28,575	108	83	31	12	1,14
UCF206-103D1	UCF206-19	F206	UC206-19G2	30,163	108	83	31	12	1,11
UCF206-104D1	UCF206-20	F206	UC206-20G2	31,75	108	83	31	12	1,10
UCF206D1	UCF206	F206	UC206G2	30	108	83	31	12	1,12
UCF207-104D1	UCF207-20	F207	UC207-20G2	31,75	117	92	34	14	1,53
UCF207-105D1	UCF207-21	F207	UC207-21G2	33,338	117	92	34	14	1,51
UCF207-106D1	UCF207-22	F207	UC207-22G2	34,925	117	92	34	14	1,48
UCF207-107D1	UCF207-23	F207	UC207-23G2	36,513	117	92	34	14	1,45
UCF207D1	UCF207	F207	UC207G2	35	117	92	34	14	1,47
UCF208-108D1	UCF208-24	F208	UC208-24G2	38,1	130	102	36	16	1,98
UCF208-109D1	UCF208-25	F208	UC208-25G2	39,688	130	102	36	16	1,95
UCF208D1	UCF208	F208	UC208G2	40	130	102	36	16	1,94
UCF209-110D1	UCF209-26	F209	UC209-26G2	41,275	137	105	38	16	2,28
UCF209-111D1	UCF209-27	F209	UC209-27G2	42,863	137	105	38	16	2,24
UCF209-112D1	UCF209-28	F209	UC209-28G2	44,45	137	105	38	16	2,20
UCF209D1	UCF209	F209	UC209G2	45	137	105	38	16	2,18
UCF210-114D1	UCF210-30	F210	UC210-30G2	47,625	143	111	40	16	2,57
UCF210-115D1	UCF210-31	F210	UC210-31G2	49,213	143	111	40	16	2,52
UCF210D1	UCF210	F210	UC210G2	50	143	111	40	16	2,50
UCF211-200D1	UCF211-32	F211	UC211-32G2	50,8	162	130	43	19	3,47
UCF211-202D1	UCF211-34	F211	UC211-34G2	53,975	162	130	43	19	3,37
UCF211-203D1	UCF211-35	F211	UC211-35G2	55,563	162	130	43	19	3,30
UCF211D1	UCF211	F211	UC211G2	55	162	130	43	19	3,32
UCF212-204D1	UCF212-36	F212	UC212-36G2	57,15	175	143	48	19	4,57
UCF212-206D1	UCF212-38	F212	UC212-38G2	60,325	175	143	48	19	4,43
UCF212-207D1	UCF212-39	F212	UC212-39G2	61,913	175	143	48	19	4,35
UCF212D1	UCF212	F212	UC212G2	60	175	143	48	19	4,43
UELF204-012D1W3	EXF204-12	F204	EX204-12G2	19,05	86	64	25,5	12	0,62
UELF204D1W3	EXF204	F204	EX204G2	20	86	64	25,5	12	0,62
UELF205-014D1W3	EXF205-14	F205	EX205-14G2	22,225	95	70	27	12	0,85
UELF205-015D1W3	EXF205-15	F205	EX205-15G2	23,813	95	70	27	12	0,85
UELF205-100D1W3	EXF205-16	F205	EX205-16G2	25,4	95	70	27	12	0,84
UELF205D1W3	EXF205	F205	EX205G2	25	95	70	27	12	0,85
UELF206-102D1W3	EXF206-18	F206	EX206-18G2	28,575	108	83	31	12	1,23
UELF206-103D1W3	EXF206-19	F206	EX206-19G2	30,163	108	83	31	12	1,20
UELF206-104D1W3	EXF206-20	F206	EX206-20G2	31,75	108	83	31	12	1,18
UELF206D1W3	EXF206	F206	EX206G2	30	108	83	31	12	1,21
UELF207-104D1W3	EXF207-20	F207	EX207-20G2	31,75	117	92	34	14	1,66
UELF207-105D1W3	EXF207-21	F207	EX207-21G2	33,338	117	92	34	14	1,64
UELF207-106D1W3	EXF207-22	F207	EX207-22G2	34,925	117	92	34	14	1,61

SNR BU CATALOGUE 4-BOLT FLANGED UNITS

Remarks

Bearing inserts use different versions of set screws.

NTN bearing inserts: UC200 / AS200: ball point type
UEL200: Cup point type (eccentric locking collar)

SNR bearing inserts: UC200 / US200 / EX200: knurled cup point type

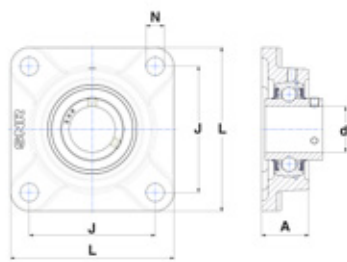

UCF200

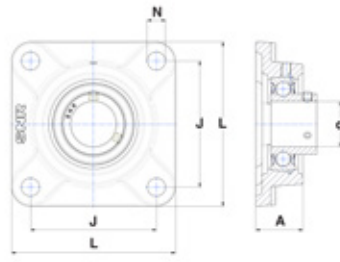

USF200

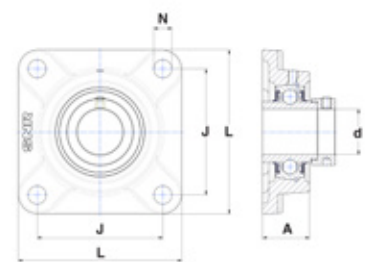

EXF200

NTN corresponding Part Number	SNR BRAND								
	SNR Part Number Bearing Unit	SNR Part Number Housing	SNR Part Number Bearing	Bore diameter (d in mm)	Housing length (L in mm)	Mounting hole distance (J in mm)	Housing height (A in mm)	Mounting bore Ø (N in mm)	Weight (kg)
UELF207-107D1W3	EXF207-23	F207	EX207-23G2	36,513	117	92	34	14	1,58
UELF207D1W3	EXF207	F207	EX207G2	35	117	92	34	14	1,60
UELF208-108D1W3	EXF208-24	F208	EX208-24G2	38,1	130	102	36	16	2,13
UELF208-109D1W3	EXF208-25	F208	EX208-25G2	39,688	130	102	36	16	2,12
UELF208D1W3	EXF208	F208	EX208G2	40	130	102	36	16	2,08
UELF209-110D1W3	EXF209-26	F209	EX209-26G2	41,275	137	105	38	16	2,46
UELF209-111D1W3	EXF209-27	F209	EX209-27G2	42,863	137	105	38	16	2,41
UELF209-112D1W3	EXF209-28	F209	EX209-28G2	44,45	137	105	38	16	2,37
UELF209D1W3	EXF209	F209	EX209G2	45	137	105	38	16	2,37
UELF210-114D1W3	EXF210-30	F210	EX210-30G2	47,625	143	111	40	16	2,80
UELF210-115D1W3	EXF210-31	F210	EX210-31G2	49,213	143	111	40	16	2,74
UELF210D1W3	EXF210	F210	EX210G2	50	143	111	40	16	2,71
UELF211-200D1W3	EXF211-32	F211	EX211-32G2	50,8	162	130	43	19	3,78
UELF211-202D1W3	EXF211-34	F211	EX211-34G2	53,975	162	130	43	19	3,58
UELF211-203D1W3	EXF211-35	F211	EX211-35G2	55,563	162	130	43	19	3,56
UELF211D1W3	EXF211	F211	EX211G2	55	162	130	43	19	3,59
UELF212-204D1W3	EXF212-36	F212	EX212-36G2	57,15	175	143	48	19	4,93
UELF212-206D1W3	EXF212-38	F212	EX212-38G2	60,325	175	143	48	19	4,70
UELF212-207D1W3	EXF212-39	F212	EX212-39G2	61,913	175	143	48	19	4,66
UELF212D1W3	EXF212	F212	EX212G2	60	175	143	48	19	4,77
ASF204-012D1	USF204-12	F204	US204-12G2	19,05	86	64	25,5	12	0,53
ASF204D1	USF204	F204	US204G2	20	86	64	25,5	12	0,53
ASF205-014D1	USF205-14	F205	US205-14G2	22,225	95	70	27	12	0,78
ASF205-015D1	USF205-15	F205	US205-15G2	23,813	95	70	27	12	0,78

SNR BU CATALOGUE 4-BOLT FLANGED UNITS

Remarks

Bearing inserts use different versions of set screws.

NTN bearing inserts: UC200 / AS200: ball point type
UEL200: Cup point type (eccentric locking collar)

SNR bearing inserts: UC200 / US200 / EX200: knurled cup point type

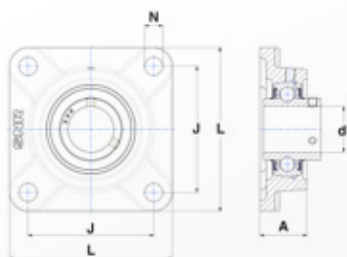

UCF200

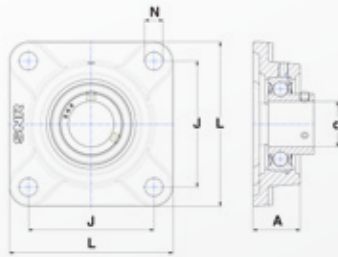

USF200

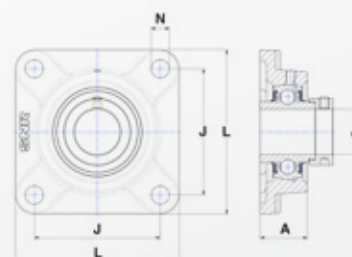

EXF200

NTN corresponding Part Number	SNR BRAND								
	SNR Part Number Bearing Unit	SNR Part Number Housing	SNR Part Number Bearing	Bore diameter (d in mm)	Housing length (L in mm)	Mounting hole distance (J in mm)	Housing height (A in mm)	Mounting bore Ø (N in mm)	Weight (kg)
ASF205-100D1	USF205-16	F205	US205-16G2	25,4	95	70	27	12	0,76
ASF205D1	USF205	F205	US205G2	25	95	70	27	12	0,77
ASF206-102D1	USF206-18	F206	US206-18G2	28,575	108	83	31	12	1,08
ASF206-103D1	USF206-19	F206	US206-19G2	30,163	108	83	31	12	1,05
ASF206-104D1	USF206-20	F206	US206-20G2	31,75	108	83	31	12	1,04
ASF206D1	USF206	F206	US206G2	30	108	83	31	12	1,07
ASF207-106D1	USF207-22	F207	US207-22G2	34,925	117	92	34	14	1,38
ASF207-107D1	USF207-23	F207	US207-23G2	36,513	117	92	34	14	1,37
ASF207D1	USF207	F207	US207G2	35	117	92	34	14	1,42
ASF208-108D1	USF208-24	F208	US208-24G2	38,1	130	102	36	16	1,90
ASF208D1	USF208	F208	US208G2	40	130	102	36	16	1,90
ASF209-110D1	USF209-26	F209	US209-26G2	41,275	137	105	38	16	2,25
ASF209-111D1	USF209-27	F209	US209-27G2	42,863	137	105	38	16	2,22
ASF209-112D1	USF209-28	F209	US209-28G2	44,45	137	105	38	16	2,17
ASF209D1	USF209	F209	US209G2	45	137	105	38	16	2,15
ASF210-114D1	USF210-30	F210	US210-30G2	47,625	143	111	40	16	2,50
ASF210-115D1	USF210-31	F210	US210-31G2	49,213	143	111	40	16	2,48
ASF210D1	USF210	F210	US210G2	50	143	111	40	16	2,46
-	USF211-32	F211	US211-32G2	50,8	162	130	43	19	3,30
-	USF211-35	F211	US211-35G2	55,563	162	130	43	19	3,25
-	USF211	F211	US211G2	55	162	130	43	19	3,27
-	USF212-36	F212	US212-36G2	57,15	175	143	48	19	4,20
-	USF212-39	F212	US212-39G2	61,913	175	143	48	19	4,12
-	USF212	F212	US212G2	60	175	143	48	19	4,20