

# SNR BU CATALOGUE BEARING INSERTS

## Remarks

Bearing inserts use different versions of set screws.

**NTN bearing inserts:** UC200 / AS200: ball point type  
UEL200: Cup point type (eccentric locking collar)

**SNR bearing inserts:** UC200 / US200 / EX200: knurled cup point type

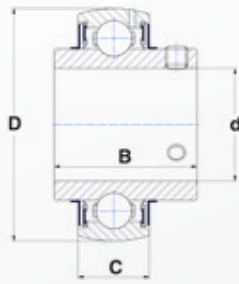

UC200G2

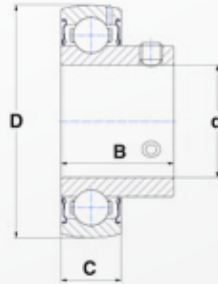

US200G2

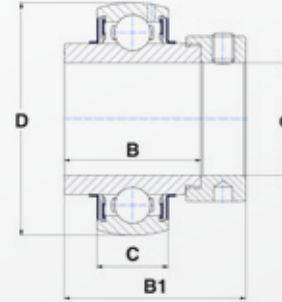

EX200G2

NTN corresponding Part Number	SNR BRAND									
	SNR Part Number	Bore diameter (d in mm)	Outer diameter (D in mm)	Width of OR (C in mm)	Width of IR (B in mm)	Overall width incl. eccent. locking collar (B1 in mm)	Weight (kg)	Dynamic load (kN)	Static load (kN)	Admissible Working Temperature range
UEL204-012D1W3	EX204-12G2	19,05	47	16	34	43,5	0,22	12,80	6,65	from -20C° to +100C°
UEL204D1W3	EX204G2	20	47	16	34	43,5	0,22	12,80	6,65	from -20C° to +100C°
UEL205-014D1W3	EX205-14G2	22,225	52	17	34,8	44,3	0,25	14,00	7,88	from -20C° to +100C°
UEL205-015D1W3	EX205-15G2	23,813	52	17	34,8	44,3	0,25	14,00	7,88	from -20C° to +100C°
UEL205-100D1W3	EX205-16G2	25,4	52	17	34,8	44,3	0,24	14,00	7,88	from -20C° to +100C°
UEL205D1W3	EX205G2	25	52	17	34,8	44,3	0,25	14,00	7,88	from -20C° to +100C°
UEL206-102D1W3	EX206-18G2	28,575	62	19	36,4	48,3	0,43	19,50	11,20	from -20C° to +100C°
UEL206-103D1W3	EX206-19G2	30,163	62	19	36,4	48,3	0,4	19,50	11,20	from -20C° to +100C°
UEL206-104D1W3	EX206-20G2	31,75	62	19	36,4	48,3	0,38	19,50	11,20	from -20C° to +100C°
UEL206D1W3	EX206G2	30	62	19	36,4	48,3	0,41	19,50	11,20	from -20C° to +100C°
UEL207-104D1W3	EX207-20G2	31,75	72	20	37,6	51,1	0,66	25,70	15,20	from -20C° to +100C°
UEL207-105D1W3	EX207-21G2	33,338	72	20	37,6	51,1	0,64	25,70	15,20	from -20C° to +100C°
UEL207-106D1W3	EX207-22G2	34,925	72	20	37,6	51,1	0,61	25,70	15,20	from -20C° to +100C°
UEL207-107D1W3	EX207-23G2	36,513	72	20	37,6	51,1	0,58	25,70	15,20	from -20C° to +100C°
UEL207D1W3	EX207G2	35	72	20	37,6	51,1	0,60	25,70	15,20	from -20C° to +100C°
UEL208-108D1W3	EX208-24G2	38,1	80	21	42,8	56,3	0,83	29,60	18,20	from -20C° to +100C°
UEL208-109D1W3	EX208-25G2	39,688	80	21	42,8	56,3	0,82	29,60	18,20	from -20C° to +100C°
UEL208D1W3	EX208G2	40	80	21	42,8	56,3	0,78	29,60	18,20	from -20C° to +100C°
UEL209-110D1W3	EX209-26G2	41,275	85	22	42,8	56,3	0,96	31,85	20,80	from -20C° to +100C°
UEL209-111D1W3	EX209-27G2	42,863	85	22	42,8	56,3	0,91	31,85	20,80	from -20C° to +100C°
UEL209-112D1W3	EX209-28G2	44,45	85	22	42,8	56,3	0,87	31,85	20,80	from -20C° to +100C°
UEL209D1W3	EX209G2	45	85	22	42,8	56,3	0,87	31,85	20,80	from -20C° to +100C°
UEL210-114D1W3	EX210-30G2	47,625	90	23	49,2	62,7	1,10	35,10	23,20	from -20C° to +100C°
UEL210-115D1W3	EX210-31G2	49,213	90	23	49,2	62,7	1,04	35,10	23,20	from -20C° to +100C°
UEL210D1W3	EX210G2	50	90	23	49,2	62,7	1,01	35,10	23,20	from -20C° to +100C°
UEL211-200D1W3	EX211-32G2	50,8	100	25	55,4	71,3	1,58	43,55	29,20	from -20C° to +100C°
UEL211-202D1W3	EX211-34G2	53,975	100	25	55,4	71,3	1,38	43,55	29,20	from -20C° to +100C°
UEL211-203D1W3	EX211-35G2	55,563	100	25	55,4	71,3	1,36	43,55	29,20	from -20C° to +100C°
UEL211D1W3	EX211G2	55	100	25	55,4	71,3	1,39	43,55	29,20	from -20C° to +100C°
UEL212-204D1W3	EX212-36G2	57,15	110	27	61,8	77,7	2,03	52,50	32,80	from -20C° to +100C°
UEL212-206D1W3	EX212-38G2	60,325	110	27	61,8	77,7	1,80	52,50	32,80	from -20C° to +100C°
UEL212-207D1W3	EX212-39G2	61,913	110	27	61,8	77,7	1,76	52,50	32,80	from -20C° to +100C°
UEL212D1W3	EX212G2	60	110	27	61,8	77,7	1,87	52,50	32,80	from -20C° to +100C°

NTN corresponding Part Number	SNR BRAND									
	SNR Part Number	Bore diameter (d in mm)	Outer diameter (D in mm)	Width of OR (C in mm)	Width of IR (B in mm)	Overall width incl. eccent. locking collar (B1 in mm)	Weight (kg)	Dynamic load (kN)	Static load (kN)	Admissible Working Temperature range
AS204-012D1	US204-12G2	19,05	47	14	25	-	0,13	12,80	6,65	from -20C° to +100C°
AS204D1	US204G2	20	47	14	25	-	0,13	12,80	6,65	from -20C° to +100C°
AS205-014D1	US205-14G2	22,225	52	15	27	-	0,18	14,00	7,88	from -20C° to +100C°
AS205-015D1	US205-15G2	23,813	52	15	27	-	0,18	14,00	7,88	from -20C° to +100C°
AS205-100D1	US205-16G2	25,4	52	15	27	-	0,16	14,00	7,88	from -20C° to +100C°
AS205D1	US205G2	25	52	15	27	-	0,17	14,00	7,88	from -20C° to +100C°
AS206-102D1	US206-18G2	28,575	62	16	30	-	0,28	19,50	11,20	from -20C° to +100C°
AS206-103D1	US206-19G2	30,163	62	16	30	-	0,25	19,50	11,20	from -20C° to +100C°
AS206-104D1	US206-20G2	31,75	62	16	30	-	0,24	19,50	11,20	from -20C° to +100C°
AS206D1	US206G2	30	62	16	30	-	0,27	19,50	11,20	from -20C° to +100C°
AS207-106D1	US207-22G2	34,925	72	17	32	-	0,38	25,70	15,20	from -20C° to +100C°
AS207-107D1	US207-23G2	36,513	72	17	32	-	0,37	25,70	15,20	from -20C° to +100C°
AS207D1	US207G2	35	72	17	32	-	0,42	25,70	15,20	from -20C° to +100C°
AS208-108D1	US208-24G2	38,1	80	18	34	-	0,60	29,60	18,20	from -20C° to +100C°
AS208D1	US208G2	40	80	18	34	-	0,60	29,60	18,20	from -20C° to +100C°
AS209-110D1	US209-26G2	41,275	85	19	41,2	-	0,75	31,85	20,80	from -20C° to +100C°
AS209-111D1	US209-27G2	42,863	85	19	41,2	-	0,72	31,85	20,80	from -20C° to +100C°
AS209-112D1	US209-28G2	44,45	85	19	41,2	-	0,67	31,85	20,80	from -20C° to +100C°
AS209D1	US209G2	45	85	19	41,2	-	0,65	31,85	20,80	from -20C° to +100C°
AS210-114D1	US210-30G2	47,625	90	20	43,5	-	0,80	35,10	23,20	from -20C° to +100C°
AS210-115D1	US210-31G2	49,213	90	20	43,5	-	0,78	35,10	23,20	from -20C° to +100C°
AS210D1	US210G2	50	90	20	43,5	-	0,76	35,10	23,20	from -20C° to +100C°
-	US211-32G2	50,8	100	23	45,3	-	1,10	43,55	29,20	from -20C° to +100C°
-	US211-35G2	55,563	100	23	45,3	-	1,05	43,55	29,20	from -20C° to +100C°
-	US211G2	55	100	23	45,3	-	1,07	43,55	29,20	from -20C° to +100C°
-	US212-36G2	57,15	110	24	53,7	-	1,30	52,50	32,80	from -20C° to +100C°
-	US212-39G2	61,913	110	24	53,7	-	1,22	52,50	32,80	from -20C° to +100C°
-	US212G2	60	110	24	53,7	-	1,30	52,50	32,80	from -20C° to +100C°