

BHTS ZZ 350° Beco Plus (UC Serie)

Insert Bearings for Extreme Temperature

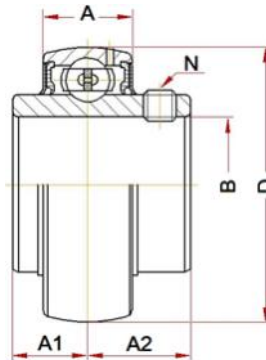
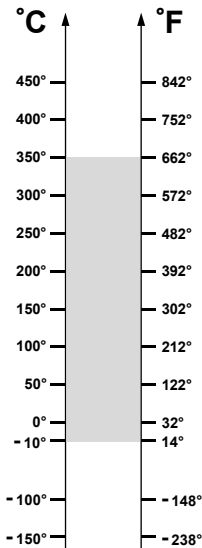

OPERATING RANGE: $-10^{\circ} / 350^{\circ}\text{C}$

ECONOMIC OPERATING RANGE: $250^{\circ} / 350^{\circ}\text{C}$

Designation	Bore (B)	Diam (D)	A	A1	A2	N	Weight, g	Limiting Speed, RPM	Static Load, kN at 350°C	Static Load, kN at 20°C
UC 201 BHTS ZZ 350° Beco Plus	12	47	13 ± 2	11,5	15,9	M6x0,75	195	300	4,55	6,60
UC 202 BHTS ZZ 350° Beco Plus	15	47	13 ± 2	11,5	15,9	M6x0,75	176	300	4,55	6,60
UC 203 BHTS ZZ 350° Beco Plus	17	47	13 ± 2	11,5	15,9	M6x0,75	170	300	4,55	6,60
UC 204 BHTS ZZ 350° Beco Plus	20	47	15 ± 2	12,7	18,3	M6x0,75	139	300	4,55	6,60
UC 205 BHTS ZZ 350° Beco Plus	25	52	16 ± 1	14,3	19,8	M6x0,75	300	280	5,39	7,80
UC 206 BHTS ZZ 350° Beco Plus	30	62	17 ± 2	15,9	22,2	M6x0,75	350	220	7,72	11,2
UC 207 BHTS ZZ 350° Beco Plus	35	72	18 ± 2	17,5	25,4	M8x1,00	500	200	10,4	15,1
UC 208 BHTS ZZ 350° Beco Plus	40	80	19 ± 2	19,0	30,2	M8x1,00	700	170	12,6	18,2
UC 209 BHTS ZZ 350° Beco Plus	45	85	20 ± 2	19,0	30,2	M8x1,00	800	160	14,2	20,6
UC 210 BHTS ZZ 350° Beco Plus	50	90	22 ± 2	19,0	32,6	M10x1,25	900	150	15,9	23,1
UC 211 BHTS ZZ 350° Beco Plus	55	100	23 ± 2	22,2	33,4	M10x1,25	1300	134	20,0	29,0
UC 212 BHTS ZZ 350° Beco Plus	60	110	24 ± 3	25,4	39,7	M10x1,25	1700	120	22,5	32,6
UC 213 BHTS ZZ 350° Beco Plus	65	120	27 ± 5	25,4	39,7	M10x1,25	1900	106	27,4	39,8
UC 214 BHTS ZZ 350° Beco Plus	70	125	28 ± 5	30,2	44,4	M12x1,50	2100	100	30,8	44,7
UC 215 BHTS ZZ 350° Beco Plus	75	130	29 ± 5	33,3	44,5	M12x1,50	2200	100	33,9	49,2

OPERATING RANGE is the correct technical range in which can be used the bearing with good operating result.

ECONOMIC OPERATING RANGE is the range of temperature in which you can find, according to our study experience and know-how, the better relation price-quality-lifetime.