

KBKC

center mount square flange

KBKC = steel with steel retainer without seal

G = resin retainer

UU = seals on both sides

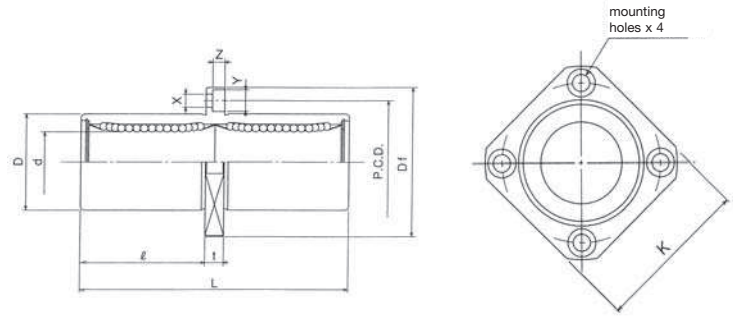

Designation		d	Tolerance d +	Tolerance d -	D	Tolerance D +	Tolerance D -	L	Tolerance L +	Tolerance L -
		mm	µm	µm	mm	µm	µm	mm	mm	mm
KBKC 8	KBKC 8G	8	9	-1	16	0	-13	46	0.3	-0.3
KBKC 12	KBKC 12G	12	9	-1	22	0	-16	61	0.3	-0.3
KBKC 16	KBKC 16G	16	11	-1	26	0	-16	68	0.3	-0.3
KBKC 20	KBKC 20G	20	11	-1	32	0	-19	80	0.3	-0.3
KBKC 25	KBKC 25G	25	13	-2	40	0	-19	112	0.3	-0.3
KBKC 30	KBKC 30G	30	13	-2	47	0	-19	123	0.3	-0.3
KBKC 40	KBKC 40G	40	16	-4	62	0	-22	154	0.3	-0.3
KBKC 50	KBKC 50G	50	16	-4	75	0	-22	192	0.3	-0.3
KBKC 60	KBKC 60G	60	16	-4	90	0	-25	211	0.3	-0.3

Outer cylinder surface treatment on request

l	Df	K	t	P.C.D.	XxYxZ	Eccentricity μm	Perpendicularity μm	Load rating		Weight
								dynamic C	static C ₀	
mm	mm	mm	mm	mm	mm			N	N	g
20.5	32	25	5	24	3.5 x 6.5 x 3.1	15	15	421	804	51
27.5	42	32	6	32	4.5 x 8 x 4.1	15	15	813	1570	90
31.0	46	35	6	36	4.5 x 8 x 4.1	15	15	921	1780	135
36.0	54	42	8	43	5.5 x 9.5 x 5.1	17	17	1370	2740	225
52.0	62	50	8	51	5.5 x 9.5 x 5.1	17	17	1570	3140	500
56.5	76	60	10	62	6.6 x 11 x 6.1	17	17	2500	5490	720
69.0	98	75	13	80	9 x 14 x 8.1	20	20	3430	8040	1600
89.5	112	88	13	94	9 x 14 x 8.1	20	20	6080	15900	2620
95.5	134	106	18	112	11 x 17.5 x 11.1	25	25	7550	20000	4480

