

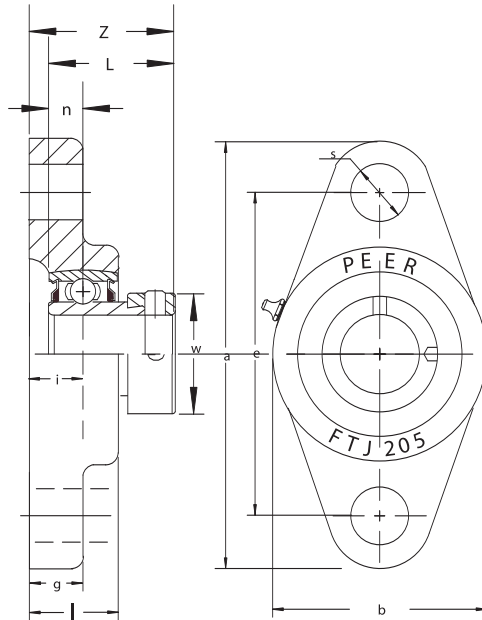

Flange Units – Narrow Steel 2 Bolt FHFTJ200-G Series Eccentric Locking Collar



- Standard duty, high-grade cast iron
- Solid base housing design for added strength
- Narrow housing follows USA/domestic dimensions
- Narrow inner ring bearing
- Relubricatable unit (shown)
- Non-relubricatable unit available (omit "G" from unit part number)
- Standard seal: RST tight riding, full cover, metal shroud seals

Optional seals: See page 85

Dimensions in mm

Unit No.	Shaft Diam.	a	e	i	g	l	s	b	Z	L	n	W	Bolt Size In.	Bearing No.	Housing No.
FHFTJ201D -8G	1/2														
FHFTJ201D -12mmG	12mm													FH201 -8G	
FHFTJ202D -9G	9/16													FH201 -12mmG	
FHFTJ202D -10G	5/8	3 29/32	3	.515	25/64	55/64	27/64	2 1/8	1.39	1.126	0.256	1.13	3/8	FH202 -9G	FTJ-203SD-H
FHFTJ202D -15mmG	15mm	99.2	76.2	13.10	10.0	21.8	11.0	54.0	35.2	28.60	6.50	28.60		FH202 -10G	
FHFTJ203D -11G	11/16													FH202 -15mmG	
FHFTJ203D -17mmG	17mm													FH203 -11G	
FHFTJ204 -12G	3/4	4 13/32	3 17/32	.406	7/16	3/4	27/64	2 9/16	1.33	1.220	0.295	1.26	3/8	FH203 -17mmG	
FHFTJ204 -20mmG	20mm	111.9	89.7	10.30	11.1	19.1	11.0	65.1	33.8	31.00	7.50	32.00		FH204 -12G	FTJ-204-H
FHFTJ205 -13G	7/8													FH204 -20mmG	
FHFTJ205 -14G	7/8	4 7/8	3 57/64	.406	7/16	25/32	17/32	2 3/4	1.33	1.220	0.295	1.50	7/16	FH205 -13G	FTJ-205-H
FHFTJ205 -15G	15/16	123.8	98.8	10.30	11.1	19.8	13.5	69.9	33.8	31.00	7.50	38.10		FH205 -14G	
FHFTJ205 -16G	1													FH205 -15G	
FHFTJ205 -25mmG	25mm													FH205 -16G	
FHFTJ206 -17G	1 1/16													FH205 -25mmG	
FHFTJ206 -18G	1 1/8	5 9/16	4 19/32	.438	17/32	27/32	17/32	3 1/8	1.49	1.406	0.354	1.75	7/16	FH206 -17G	FTJ-206-H
FHFTJ206 -19G	1 3/16	141.3	116.7	11.10	13.5	21.4	13.5	79.4	37.8	35.70	9.00	44.50		FH206 -18G	
FHFTJ206 -20G	1 7/4(s)													FH206 -19G	
FHFTJ206 -30mmG	30mm													FH206 -20G	
FHFTJ207 -20G	1 1/4													FH206 -30mmG	
FHFTJ207 -21G	1 5/16	6 1/8	5 1/8	.484	9/16	31/32	37/64	3 5/8	1.64	1.531	0.374	2.19	1/2	FH207 -20G	FTJ-207-H
FHFTJ207 -22G	1 3/8	155.6	130.2	12.30	14.3	24.6	15.0	92.1	41.7	38.90	9.50	55.60		FH207 -21G	
FHFTJ207 -23G	1 7/16													FH207 -22G	
FHFTJ207 -35mmG	35mm													FH207 -23G	
FHFTJ208 -24G	1 1/2	6 3/4	5 21/32	.516	9/16	1 1/32	17/32	4 1/8	1.80	1.720	0.433	2.38	1/2	FH207 -35mmG	
FHFTJ208 -25G	1 9/16	171.5	143.7	13.10	14.3	26.2	13.5	104.8	45.8	43.70	11.00	60.40		FH208 -24G	FTJ-208-H
FHFTJ208 -40mmG	40mm													FH208 -25G	
FHFTJ209 -26G	1 5/8													FH208 -40mmG	
FHFTJ209 -27G	1 11/16	7 1/16	5 27/32	.594	5/8	1 1/8	37/64	4 3/8	1.88	1.720	0.433	2.50	1/2	FH209 -26G	FTJ-209-H
FHFTJ209 -28G	1 3/4	179.4	148.4	15.10	15.9	28.6	15.0	111.1	47.8	43.70	11.00	63.50		FH209 -27G	
FHFTJ209 -45mmG	45mm													FH209 -28G	
FHFTJ210 -29G	1 13/16													FH209 -45mmG	
FHFTJ210 -30G	1 7/8	7 7/16	6 3/16	.594	29/32	1 11/16	37/64	4 35/64	1.88	1.720	0.433	2.75	1/2	FH210 -29G	FTJ-210-H
FHFTJ210 -31G	1 15/16	188.9	157.2	15.10	11.5	42.9	15.0	115.5	47.8	43.70	11.00	69.90		FH210 -30G	
FHFTJ210 -32G	2(s)													FH210 -31G	
FHFTJ210 -50mmG	50mm													FH210 -32G	
FHFTJ211 -32G	2													FH210 -50mmG	
FHFTJ211 -33G	2 1/16	8 3/16	7 1/4	.738	43/64	1 29/64	45/64	5 3/64	2.15	1.906	0.492	3.00	11/16	FH211 -32G	FTJ-211-H
FHFTJ211 -34G	2 1/8	223.8	184.2	18.70	17.1	36.9	17.9	128.2	54.6	48.40	12.50	76.20		FH211 -33G	
FHFTJ211 -35G	2 3/16													FH211 -34G	
FHFTJ211 -55mmG	55mm													FH211 -35G	

1. Units available with "FHS" set screw locking style bearings
Example: FHSFTJ205-16G
2. Bolt hole diameter ('s' dimension) can be drilled to your specifications