

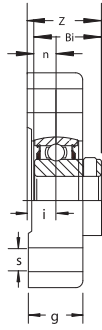

# Flange Units – Round Hole 3 Bolt

## FHSF3C200-G / FHF3C200-G Series



FHSF3C200-G

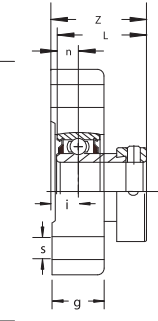
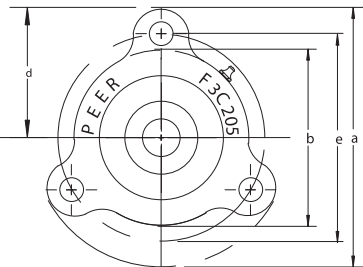

FHF3C200-G

- Standard duty, high-grade cast iron
- Solid Foot housing design
- Narrow inner ring bearing
- Relubricatable unit (shown)
- Non-relubricatable unit available (omit "G" from unit part number)
- Standard seal: RST tight riding, full cover, metal shroud seals

Optional seals: See page 85

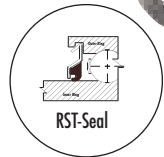

### FHSF3C200-G Set Screw Locking

Unit No.	Shaft Diam.	Dimensions <sup>in</sup> / <sub>mm</sub>										Bolt Size In.	Bearing No.	Housing No.
		a	e	i	b	d	g	s	Z	Bi	n			
FHSF3C204 -12G FHSF3C204 -13G FHSF3C204 -20mmG	3/4 13/16 20mm	3 9/16 90.5	2 13/16 71.4	.344 8.73	1 25/32 66.7	1 25/32 45.2	11/16 17.5	11/32 8.7	1.03 26.2	0.9843 25.000	0.295 7.50	5/16	FHS204 -12-GO FHS204 -13-GO FHS204 -20mm-GO	F3C-204-H
FHSF3C205 -12G FHSF3C205 -13G FHSF3C205 -14G FHSF3C205 -15G FHSF3C205 -16G FHSF3C205 -25mmG	3/4 13/16 7/8 15/16 1 25mm	3 3/4 95.3	3 76.2	.373 9.47	2 51/64 71.0	1 7/8 47.6	11/16 17.5	11/32 8.7	1.14 29.0	1.0630 27.000	0.295 7.50	5/16	FHS205 -12-GO FHS205 -13-GO FHS205 -14-GO FHS205 -15-GO FHS205 -16-GO FHS205 -25mm-GO	F3C-205-H
FHSF3C206 -17G FHSF3C206 -18G FHSF3C206 -19G FHSF3C206 -20G FHSF3C206 -30mmG	1 1/16 1 1/8 1 3/16 1 1/4(s) 30mm	4 7/16 112.7	3 9/16 90.5	.462 11.73	3 5/16 84.1	2 7/32 56.4	13/16 20.6	13/32 10.3	1.29 32.7	1.1811 30.000	0.354 9.00	3/8	FHS206 -17-GO FHS206 -18-GO FHS206 -19-GO FHS206 -20-GO FHS206 -30mm-GO	F3C-206-H
FHSF3C207 -20G FHSF3C207 -21G FHSF3C207 -22G FHSF3C207 -23G FHSF3C207 -35mmG	1 1/4 1 5/16 1 3/8 1 7/16 35mm	4 15/16 125.4	3 15/16 100.0	.497 12.62	3 11/16 93.7	2 15/32 62.7	7/8 22.2	13/32 10.3	1.38 35.1	1.2598 32.000	0.374 9.50	3/8	FHS207 -20-GO FHS207 -21-GO FHS207 -22-GO FHS207 -23-GO FHS207 -35mm-GO	F3C-207-H

### FHF3C200-G Eccentric Collar Locking

Unit No.	Shaft Diam.	Dimensions <sup>in</sup> / <sub>mm</sub>										Bolt Size In.	Bearing No.	Housing No.
		a	e	i	b	d	g	s	Z	L	n			
FHF3C204 -12G FHF3C204 -20mmG	3/4 20mm	3 9/16 90.5	2 13/16 71.4	.344 8.73	1 25/32 66.7	1 25/32 45.2	11/16 17.5	11/32 8.7	1.27 32.2	1.2205 31.000	0.295 7.50	5/16	FH204 -12-GO FH204 -20mm-GO	F3C-204-H
FHF3C205 -13G FHF3C205 -14G FHF3C205 -15G FHF3C205 -16G FHF3C205 -25mmG	13/16 7/8 15/16 1 25mm	3 3/4 95.3	3 76.2	.373 9.47	2 51/64 71.0	1 7/8 47.6	11/16 17.5	11/32 8.7	1.30 33.0	1.2205 31.000	0.295 7.50	5/16	FH205 -13-GO FH205 -14-GO FH205 -15-GO FH205 -16-GO FH205 -25mm-GO	F3C-205-H
FHF3C206 -17G FHF3C206 -18G FHF3C206 -19G FHF3C206 -20G FHF3C206 -30mmG	1 1/16 1 1/8 1 3/16 1 1/4(s) 30mm	4 7/16 112.7	3 9/16 90.5	.462 11.73	3 5/16 84.1	2 7/32 56.4	13/16 20.6	13/32 10.3	1.51 38.4	1.4055 35.700	0.354 9.00	3/8	FH206 -17-GO FH206 -18-GO FH206 -19-GO FH206 -20-GO FH206 -30mm-GO	F3C-206-H
FHF3C207 -20G FHF3C207 -21G FHF3C207 -22G FHF3C207 -23G FHF3C207 -35mmG	1 1/4 1 5/16 1 3/8 1 7/16 35mm	4 15/16 125.4	3 15/16 100.0	.497 12.62	3 11/16 93.7	2 15/32 62.7	7/8 22.2	13/32 10.3	1.65 42.0	1.5315 38.900	0.374 9.50	3/8	FH207 -20-GO FH207 -21-GO FH207 -22-GO FH207 -23-GO FH207 -35mm-GO	F3C-207-H

Bolt hole diameter ('s' dimension) can be drilled to your specifications