

Cylindrical inner rings with hole for RNA bearings - Summary table

BIC and BICG series

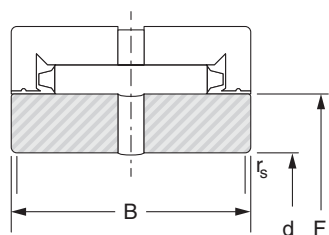

BIC

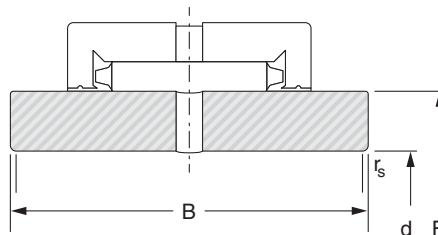

BICG

| Shaft Ø mm | Designation | d mm | F mm | B mm | r _s min mm | Weight kg |
|------------------|-------------|---------|---------|---------|--------------------------|--------------|
| 12 | BIC 1012 | 12 | 17.6 | 15 | 1 | 0.016 |
| 15 | BIC 1015 | 15 | 20.8 | 15 | 1 | 0.018 |
| | BIC 2015 | 15 | 22.1 | 22 | 1 | 0.035 |
| 17 | BIC 1017 | 17 | 23.9 | 15 | 1 | 0.026 |
| 20 | BIC 1020 | 20 | 28.7 | 18 | 1 | 0.046 |
| | BIC 2020 | 20 | 28.7 | 22 | 1 | 0.056 |
| 25 | BIC 1025 | 25 | 33.5 | 18 | 1 | 0.054 |
| | BIC 2025 | 25 | 33.5 | 22 | 1 | 0.065 |
| | BIC 22025 | 25 | 33.5 | 30 | 1 | 0.500 |
| 30 | BIC 1030 | 30 | 38.2 | 18 | 1 | 0.060 |
| | BIC 2030 | 30 | 38.2 | 22 | 1 | 0.074 |
| | BIC 3030 | 30 | 44.0 | 30 | 1 | 0.188 |
| 35 | BIC 1035 | 35 | 44.0 | 18 | 1 | 0.077 |
| | BIC 2035 | 35 | 44.0 | 22 | 1 | 0.093 |
| 40 | BIC 1040 | 40 | 49.7 | 18 | 1.5 | 0.094 |
| | BIC 2040 | 40 | 49.7 | 22 | 1.5 | 0.115 |
| | BIC 3040 | 40 | 55.4 | 36 | 1.5 | 0.321 |
| 45 | BIC 1045 | 45 | 55.4 | 18 | 1.5 | 0.113 |
| | BIC 2045 | 45 | 55.4 | 22 | 1.5 | 0.139 |
| | BIC 3045 | 45 | 62.1 | 38 | 1.5 | 0.422 |

Cylindrical inner rings with hole for RNA bearings - Summary table

BIC and BICG series

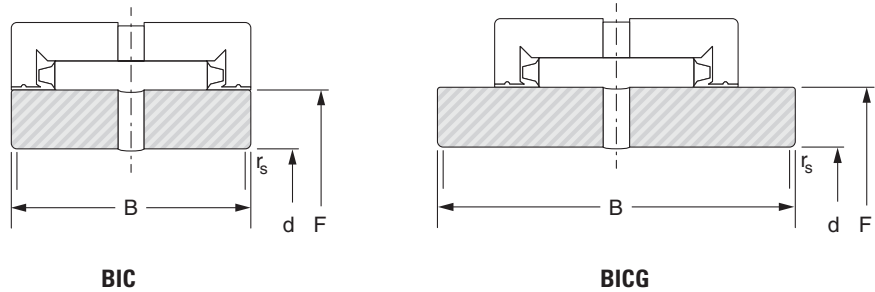

| Shaft ∅ mm | Designation | d mm | F mm | B mm | r _s min mm | Weight kg |
|------------------|-------------|---------|---------|---------|--------------------------|--------------|
| 50 | BIC 1050 | 50 | 62.1 | 20 | 2 | 0.163 |
| | BIC 11050 | 50 | 62.1 | 24 | 2 | 0.196 |
| | BIC 2050 | 50 | 62.1 | 28 | 2 | 0.228 |
| | BIC 3050 | 50 | 68.8 | 38 | 2 | 0.515 |
| 55 | BIC 1055 | 55 | 68.8 | 20 | 2 | 0.205 |
| | BIC 3055 | 55 | 72.6 | 38 | 2 | 0.525 |
| | BICG 3055 | 55 | 72.6 | 48 | 2 | 0.660 |
| 60 | BIC 2060 | 60 | 72.6 | 28 | 2 | 0.282 |
| | BIC 3060 | 60 | 78.3 | 38 | 2 | 0.583 |
| | BICG 2060 | 60 | 72.6 | 38 | 2 | 0.385 |
| 65 | BIC 3065 | 65 | 83.1 | 38 | 2 | 0.623 |
| 70 | BIC 3070 | 70 | 88.0 | 38 | 2 | 0.662 |
| 75 | BIC 2075 | 75 | 88.0 | 32 | 2 | 0.410 |
| 80 | BIC 1080 | 80 | 96.0 | 24 | 2 | 0.410 |
| | BIC 2080 | 80 | 96.0 | 32 | 2 | 0.545 |
| | BIC 3080 | 80 | 99.5 | 38 | 2 | 0.805 |
| 90 | BIC 2090 | 90 | 104.7 | 32 | 2 | 0.531 |
| | BIC 3090 | 90 | 109.1 | 43 | 2 | 0.990 |
| 95 | BIC 2095 | 95 | 109.1 | 32 | 2 | 0.548 |
| | BIC 3095 | 95 | 114.7 | 43 | 2 | 1.075 |
| 100 | BIC 3100 | 100 | 119.2 | 43 | 2 | 1.090 |
| 105 | BIC 2105 | 105 | 119.2 | 32 | 2 | 0.615 |
| 110 | BIC 2110 | 110 | 124.7 | 34 | 2 | 0.705 |
| 125 | BICG 2125 | 125 | 142.5 | 44 | 2 | 1.340 |
| 130 | BIC 3130 | 130 | 158.0 | 52 | 2 | 2.530 |