

## Needle Bearing Cam Followers - Chrome Plated

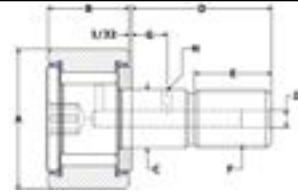

### Chrome Plated Standard Hexed Sealed Cam Follower

Part Number	Roller		Stud				Lubrication			Other Specs				
	A	B	C	D	E	F	G	H	J	Min. Boss Diameter	Recom. Bore Diameter +.0005 - .0000	**Recom. Torque (in lb)	Max Static Capacity (lbf)	Basic Dynamic Rating (lbf)
Cylindrical	Roller O.D. +.000 - .001	Roller Width +.000 - .005	Stud Diameter +.001 - .000	Stud Length +.010 - .010	M.E.T.	Thread Class 2A	Oil Hole Center	Oil Hole Diameter	Lube Fitting Size					
CNB-16-SBC	0.500	0.375	0.190	0.625	0.250	10-32	-	-	-	19/64	0.190	15	300	610
CNB-20-SBC	0.625	0.4375	0.250	0.750	0.312	1/4-28	-	-	-	23/64	0.250	35	600	860
CNB-24-SBC	0.750	0.500	0.375	0.875	0.375	3/8-24	1/4	3/32	3/16	1/2	0.375	95	1,500	1,490
CNB-32-SBC	1.000	0.625	0.4375	1.000	0.500	7/16-20	1/4	3/32	3/16	41/64	0.438	250	1,800	2,000
CNB-40-SBC	1.250	0.750	0.500	1.250	0.625	1/2-20	5/16	3/32	3/16	49/64	0.500	350	2,300	3,530
CNB-48-SBC	1.500	0.875	0.625	1.500	0.750	5/8-18	3/8	3/32	3/16	57/64	0.625	650	4,000	4,350
CNB-56-SBC	1.750	1.000	0.750	1.750	0.875	3/4-16	7/16	3/32	3/16	1 3/64	0.750	1,250	6,000	5,730
CNB-64-SBC	2.000	1.250	0.875	2.000	1.000	7/8-14	1/2	1/8	3/16	1 13/64	0.875	1,500	8,200	7,270

## Needle Bearing Cam Followers & Yoke Rollers - Standard Urethane

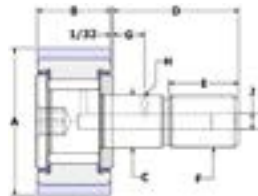

### Standard Urethane Cam Follower

Part Number	Roller		Stud				Lubrication			Other Specs				
	A	B	C	D	E	F	G	H	J	Min. Boss Diameter	Recom. Bore Diameter +.0005 - .0000	**Recom. Torque Inch Pounds		
Cylindrical	Roller O.D.	Roller Width	Stud Diameter +.001 - .000	Stud Length +.010 - .010	M.E.T.	Thread Class 2A	Oil Hole Center	Oil Hole Diameter	Lube Fitting Size					
CRT-24-SB	0.750	0.375	0.190	0.625	0.250	10-32	-	-	-	19/64	0.190	15		
CRT-32-SB	1.000	0.500	0.375	0.875	0.375	3/8-24	1/4	3/32	3/16	1/2	0.375	15		
CRT-40-SB	1.250	0.625	0.4375	1.000	0.500	7/16-20	1/4	3/32	3/16	41/64	0.4375	35		
CRT-48-SB	1.500	0.750	0.500	1.250	0.625	1/2-20	5/16	3/32	3/16	49/64	0.500	35		
CRT-56-SB	1.750	0.875	0.625	1.500	0.750	5/8-18	3/8	3/32	3/16	57/64	0.625	35		
CRT-64-SB	2.000	1.000	0.750	1.750	0.875	3/4-16	7/16	3/32	3/16	1 3/64	0.750	95		
CRT-72-SB	2.250	1.250	0.875	2.000	1.000	7/8-14	1/2	1/8	3/16	1 13/64	0.875	95		

### Standard Urethane Yoke Roller

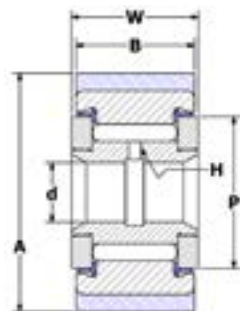

Part Number	Roller		Inner Ring	Assembly	Other Specs		
	A	B	d	W	H	P	
Cylindrical	Roller O.D.	Roller Width	Bore Diameter +.0002 - .0004	Overall Width +.005 - .010	Oil Hole Diameter	Min Boss Diameter	Shaft Diameter +.0002 - .0001
YRT-32-S	1.000	0.500	0.250	0.5625	3/32	5/8	0.2497
YRT-40-S	1.250	0.625	0.3125	0.6875	3/32	23/32	0.3122
YRT-48-S	1.500	0.750	0.375	0.8125	3/32	1	0.3747
YRT-56-S	1.750	0.875	0.4375	0.9375	3/32	1 1/8	0.4372
YRT-64-S	2.000	1.000	0.500	1.0625	3/32	1 1/4	0.4997
YRT-72-S	2.250	1.250	0.625	1.3125	3/32	1 1/2	0.6247

\*\*Clamping torque is based on lubricated threads, if threads are dry, double the value listed. Carter does not recommend any load that causes more than 20% compression of polyurethane tire, exceeding this will cause delamination. If a heavy load is required, please contact Carter Customer Service for help with a solution for your application

# Special Bearings



Need a Bearing for a Special Application?

**CARTER** specializes in custom bearings so we can respond to your design and scheduling requirements. Often at **lower** cost and quick lead times.



**FREE LASER ETCHING**