

DOUBLE ROW BEARINGS
ZWEIREIHIGES KEGELROLLENLAGER
ROULEMENTS A DOUBLE RANGÉE DE ROULEAUX

| H | J | da | L | R | Weight Gew. Poids kg | † | | * | | Speed rpm Drehzahl U/min Vitesse tr/mn max | Bearing Number Kurzzeichen Symbolisation | |
|------|--------|----|---|------|-------------------------------|-------|------|------|------|--|--|------------------------------|
| | | | | | | daN/μ | | daN | | | Cone Innenring Cône | Cup Aussenring Cuvette |
| | | | | | | Rad. | Axi. | Rad. | Axi. | | | |
| 3,00 | 55,00 | 34 | 5 | 1,50 | 0,480 | 54 | 4 | 850 | 210 | 13300 | 74025 | / 74052H |
| 4,00 | 66,00 | 40 | 5 | 1,50 | 0,660 | 84 | 7 | 1250 | 345 | 11600 | 70030 | / 70062H |
| 4,00 | 70,67 | 44 | 5 | 1,50 | 0,800 | 84 | 7 | 1410 | 405 | 10400 | 80030 | / 80066XH |
| 4,00 | 72,00 | 44 | 5 | 1,50 | 0,800 | 84 | 7 | 1410 | 405 | 10400 | 80030 | / 80068H |
| 4,00 | 76,00 | 45 | 5 | 2,00 | 0,860 | 94 | 7 | 2045 | 545 | 9600 | 100031X | / 100072H |
| 4,00 | 76,20 | 45 | 5 | 2,00 | 0,860 | 94 | 7 | 2045 | 545 | 9600 | 100031X | / 100076XH |
| 4,00 | 84,00 | 45 | 5 | 2,00 | 0,860 | 94 | 7 | 2045 | 545 | 9600 | 100031X | / 100080H |
| 4,00 | 70,67 | 44 | 5 | 1,50 | 0,800 | 84 | 7 | 1410 | 405 | 10400 | 80033X | / 80066XH |
| 4,00 | 72,00 | 44 | 5 | 1,50 | 0,800 | 84 | 7 | 1410 | 405 | 10400 | 80033X | / 80068H |
| 4,00 | 76,00 | 45 | 5 | 2,00 | 0,860 | 94 | 7 | 2045 | 545 | 9600 | 100034X | / 100072H |
| 4,00 | 76,20 | 45 | 5 | 2,00 | 0,860 | 94 | 7 | 2045 | 545 | 9600 | 100034X | / 100076XH |
| 4,00 | 84,00 | 45 | 5 | 2,00 | 0,860 | 94 | 7 | 2045 | 545 | 9600 | 100034X | / 100080H |
| 4,00 | 70,67 | 44 | 5 | 1,50 | 0,740 | 84 | 7 | 1410 | 405 | 10400 | 80035 | / 80066XH |
| 4,00 | 76,00 | 45 | 5 | 2,00 | 0,855 | 94 | 7 | 2045 | 545 | 9600 | 100035 | / 100072H |
| 4,00 | 76,20 | 45 | 5 | 2,00 | 0,860 | 94 | 7 | 2045 | 545 | 9600 | 100035 | / 100076XH |
| 4,00 | 84,00 | 45 | 5 | 2,00 | 0,860 | 94 | 7 | 2045 | 545 | 9600 | 100035 | / 100080H |
| 4,00 | 76,00 | 48 | 5 | 3,50 | 0,595 | 56 | 5 | 1280 | 350 | 9600 | 102036 | / 102072H |
| 4,00 | 80,00 | 52 | 5 | 2,00 | 0,865 | 102 | 9 | 2175 | 630 | 8800 | 101038X | / 101076H |
| 4,00 | 80,20 | 52 | 5 | 2,00 | 0,865 | 102 | 9 | 2175 | 630 | 8800 | 101038X | / 101076XH |
| 4,00 | 84,00 | 52 | 5 | 2,00 | 0,865 | 102 | 9 | 2175 | 630 | 8800 | 101038X | / 101080H |
| 4,00 | 80,00 | 52 | 5 | 2,00 | 0,865 | 102 | 9 | 2175 | 630 | 8800 | 101040 | / 101076H |
| 4,00 | 80,20 | 52 | 5 | 2,00 | 0,865 | 102 | 9 | 2175 | 630 | 8800 | 101040 | / 101076XH |
| 4,00 | 84,00 | 52 | 5 | 2,00 | 1,070 | 102 | 9 | 2175 | 630 | 8800 | 101040 | / 101080H |
| 4,76 | 89,76 | 55 | 6 | 2,00 | 1,130 | 88 | 7 | 2190 | 600 | 8200 | 112040 | / 112085H |
| 4,00 | 80,00 | 52 | 5 | 2,00 | 0,865 | 102 | 9 | 2175 | 630 | 8800 | 101041X | / 101076H |
| 4,00 | 80,20 | 52 | 5 | 2,00 | 0,865 | 102 | 9 | 2175 | 630 | 8800 | 101041X | / 101076XH |
| 4,00 | 84,00 | 52 | 5 | 2,00 | 0,865 | 102 | 9 | 2175 | 630 | 8800 | 101041X | / 101080H |
| 4,76 | 89,76 | 55 | 6 | 2,00 | 1,110 | 88 | 7 | 2190 | 600 | 8200 | 112041X | / 112085H |
| 4,76 | 89,76 | 55 | 6 | 2,00 | 1,110 | 88 | 7 | 2190 | 600 | 8200 | 112044X | / 112085H |
| 4,76 | 89,76 | 55 | 6 | 2,00 | 1,190 | 112 | 9 | 2680 | 730 | 8200 | 119044X | / 119085H |
| 4,76 | 93,66 | 55 | 6 | 2,00 | 1,190 | 112 | 9 | 2680 | 730 | 8200 | 119044X | / 119088XH |
| 4,76 | 94,76 | 62 | 7 | 2,00 | 1,380 | 120 | 11 | 2805 | 830 | 7400 | 111044X | / 111090H |
| 4,76 | 98,00 | 62 | 7 | 2,00 | 1,380 | 120 | 11 | 2805 | 830 | 7400 | 111044X | / 111093XH |
| 4,76 | 89,76 | 55 | 6 | 2,00 | 1,110 | 88 | 7 | 2190 | 600 | 8200 | 112045 | / 112085H |
| 4,76 | 89,76 | 55 | 6 | 2,00 | 1,190 | 112 | 9 | 2680 | 730 | 8200 | 119045 | / 119085H |
| 4,76 | 93,66 | 55 | 6 | 2,00 | 1,190 | 112 | 9 | 2680 | 730 | 8200 | 119045 | / 119088XH |
| 4,76 | 94,76 | 62 | 7 | 3,00 | 1,380 | 120 | 11 | 2805 | 830 | 7400 | 111050 | / 111090H |
| 4,76 | 98,00 | 62 | 7 | 2,00 | 1,380 | 120 | 11 | 2805 | 830 | 7400 | 111050 | / 111093XH |
| 4,50 | 101,34 | 70 | 7 | 2,00 | 2,005 | 136 | 13 | 3070 | 990 | 6900 | 110050 | / 110096XH |
| 4,50 | 102,93 | 70 | 7 | 2,00 | 2,005 | 136 | 13 | 3070 | 990 | 6900 | 110050 | / 110098XH |
| 4,50 | 104,50 | 70 | 7 | 2,00 | 2,005 | 136 | 13 | 3070 | 990 | 6900 | 110050 | / 110100H |
| 4,76 | 94,76 | 62 | 7 | 2,00 | 1,380 | 120 | 11 | 2805 | 830 | 7400 | 111050X | / 111090H |
| 4,50 | 101,34 | 70 | 7 | 2,00 | 2,005 | 136 | 13 | 3070 | 990 | 6900 | 110050X | / 110096XH |
| 4,50 | 102,93 | 70 | 7 | 2,00 | 2,005 | 136 | 13 | 3070 | 990 | 6900 | 110050X | / 110098XH |
| 4,50 | 104,50 | 70 | 7 | 2,00 | 2,005 | 136 | 13 | 3070 | 990 | 6900 | 110050X | / 110100H |
| 4,50 | 101,34 | 70 | 7 | 2,00 | 2,005 | 136 | 13 | 3070 | 990 | 6900 | 110053X | / 110096XH |
| 4,50 | 102,93 | 70 | 7 | 2,00 | 2,005 | 136 | 13 | 3070 | 990 | 6900 | 110053X | / 110098XH |
| 4,50 | 104,50 | 70 | 7 | 2,00 | 2,005 | 136 | 13 | 3070 | 990 | 6900 | 110053X | / 110100H |
| 4,50 | 101,34 | 70 | 7 | 2,00 | 2,005 | 136 | 13 | 3070 | 990 | 6900 | 110055 | / 110096XH |
| 4,50 | 102,93 | 70 | 7 | 2,00 | 2,005 | 136 | 13 | 3070 | 990 | 6900 | 110055 | / 110098XH |

Wichtiger Hinweis: Bei zweireihigen Lagern ist die Bohrung des hinteren Innenrings (Markierung 'B-Laufbahn') 0,002 bis 0,004mm grösser als die Bohrung der 'A'-Laufbahn. Dies erweitert den Sitz der Passung und erleichtert das Einstellen des Lagers.

Note importante: Pour les roulements à double rangée, l'alésage du cône arrière (marqué 'B') est plus grand de 0,002 à 0,004mm que l'alésage du cône marqué 'A'. Ceci réduit le serrage de l'ajustement pour faciliter le montage du roulement.

**FLANGED CUP (H TYPE)
 AUSSENRING MIT BUND (TYP H)
 BAGUE EXTERIEURE A COLLERETTE (TYPE H)**

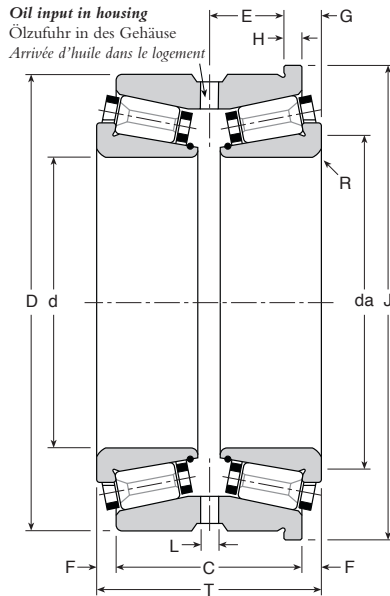

- da - Recommended shaft abutment diameter
 empfohlener Durchmesser des Wellen-Widerlagers
 diamètre recommandé d'épaulement de l'arbre
- L - 6 equally spaced holes (diameter)
 6 Bohrungen am Umfang
 6 trous équidistants
- † - Static Stiffness
 Statische Steifigkeit
 Rigidité statique
- * - Basic Rating 10,000hrs@500rpm
 Belastung 10,000h@500U/min
 Capacité 10,000h@500tr/mn

**Manufacturing Tolerances
 Fertigungstoleranzen
 Tolérances de fabrication**

| | d ≤ 180mm | d > 180mm |
|-------------------|-------------|-------------|
| Bore d | +0,005 0 | +0,010 0 |
| Diameter D | +0,005 0 | +0,010 0 |
| Width G | ±0,25 | ±0,25 |
| Overall width T | ±0,50 | ±0,50 |
| Flange diameter J | 0 -0,10 | 0 -0,10 |
| Flange width H | ±0,05 | ±0,05 |

| d | D | T | C | E | F | G |
|--------|---------|-------|-------|-------|------|-------|
| 55,000 | 100,000 | 65,00 | 54,00 | 22,50 | 5,50 | 10,00 |
| 57,150 | 96,838 | 65,00 | 54,00 | 22,50 | 5,50 | 10,00 |
| 57,150 | 96,838 | 65,00 | 54,00 | 22,50 | 5,50 | 10,00 |
| 57,150 | 100,000 | 65,00 | 54,00 | 22,50 | 5,50 | 10,00 |
| 57,150 | 100,000 | 58,00 | 46,88 | 18,94 | 5,56 | 10,06 |
| 57,150 | 101,600 | 58,00 | 46,88 | 18,94 | 5,56 | 10,06 |
| 57,150 | 110,000 | 73,00 | 60,30 | 25,39 | 6,35 | 11,11 |
| 57,150 | 112,712 | 73,00 | 60,30 | 25,39 | 6,35 | 11,11 |
| 60,000 | 100,000 | 58,00 | 46,88 | 18,94 | 5,56 | 10,06 |
| 60,000 | 101,600 | 58,00 | 46,88 | 18,94 | 5,56 | 10,06 |
| 60,000 | 110,000 | 73,00 | 60,30 | 25,39 | 6,35 | 11,11 |
| 60,000 | 112,712 | 73,00 | 60,30 | 25,39 | 6,35 | 11,11 |
| 60,000 | 120,000 | 71,00 | 59,88 | 24,39 | 5,56 | 11,11 |
| 60,000 | 127,000 | 71,00 | 59,88 | 24,39 | 5,56 | 11,11 |
| 60,325 | 100,000 | 58,00 | 46,88 | 18,94 | 5,56 | 10,06 |
| 60,325 | 101,600 | 58,00 | 46,88 | 18,94 | 5,56 | 10,06 |
| 63,500 | 110,000 | 73,00 | 60,30 | 25,39 | 6,35 | 11,11 |
| 63,500 | 120,000 | 71,00 | 59,88 | 24,39 | 5,56 | 11,11 |
| 63,500 | 127,000 | 71,00 | 59,88 | 24,39 | 5,56 | 11,11 |
| 65,000 | 120,000 | 71,00 | 59,88 | 24,39 | 5,56 | 11,11 |
| 65,000 | 127,000 | 71,00 | 59,88 | 24,39 | 5,56 | 11,11 |
| 69,850 | 127,000 | 71,00 | 59,88 | 24,39 | 5,56 | 11,11 |
| 69,850 | 112,712 | 73,00 | 60,30 | 25,39 | 6,35 | 11,11 |
| 69,850 | 120,000 | 71,00 | 59,88 | 24,39 | 5,56 | 11,11 |
| 69,850 | 120,000 | 89,00 | 73,12 | 30,21 | 7,94 | 14,29 |
| 70,000 | 112,712 | 73,00 | 60,30 | 25,39 | 6,35 | 11,11 |
| 70,000 | 120,000 | 71,00 | 59,88 | 24,39 | 5,56 | 11,11 |
| 70,000 | 127,000 | 71,00 | 59,88 | 24,39 | 5,56 | 11,11 |
| 73,025 | 120,000 | 64,00 | 49,70 | 19,30 | 7,15 | 12,70 |
| 73,025 | 120,650 | 64,00 | 49,70 | 19,30 | 7,15 | 12,70 |
| 73,025 | 121,444 | 64,00 | 49,70 | 19,30 | 7,15 | 12,70 |
| 73,025 | 123,825 | 64,00 | 49,70 | 19,30 | 7,15 | 12,70 |
| 75,000 | 120,000 | 64,00 | 49,70 | 19,30 | 7,15 | 12,70 |
| 75,000 | 120,650 | 64,00 | 49,70 | 19,30 | 7,15 | 12,70 |
| 75,000 | 121,444 | 64,00 | 49,70 | 19,30 | 7,15 | 12,70 |
| 75,000 | 123,825 | 64,00 | 49,70 | 19,30 | 7,15 | 12,70 |
| 75,000 | 127,000 | 73,00 | 60,50 | 24,70 | 6,25 | 11,80 |
| 75,000 | 130,000 | 73,00 | 60,50 | 24,70 | 6,25 | 11,80 |
| 75,000 | 133,350 | 73,00 | 60,50 | 24,70 | 6,25 | 11,80 |
| 75,000 | 136,525 | 73,00 | 60,50 | 24,70 | 6,25 | 11,80 |
| 76,200 | 120,000 | 64,00 | 49,70 | 19,30 | 7,15 | 12,70 |
| 76,200 | 120,650 | 64,00 | 49,70 | 19,30 | 7,15 | 12,70 |
| 76,200 | 123,825 | 64,00 | 49,70 | 19,30 | 7,15 | 12,70 |
| 76,200 | 127,000 | 73,00 | 60,50 | 24,70 | 6,25 | 11,80 |
| 76,200 | 130,000 | 73,00 | 60,50 | 24,70 | 6,25 | 11,80 |
| 76,200 | 133,350 | 73,00 | 60,50 | 24,70 | 6,25 | 11,80 |
| 76,200 | 136,525 | 73,00 | 60,50 | 24,70 | 6,25 | 11,80 |
| 77,788 | 120,000 | 64,00 | 49,70 | 19,30 | 7,15 | 12,70 |
| 77,788 | 120,650 | 64,00 | 49,70 | 19,30 | 7,15 | 12,70 |
| 77,788 | 121,444 | 64,00 | 49,70 | 19,30 | 7,15 | 12,70 |

Important note: For double row bearings the bore of the rear cone (marked 'B' track) is 0,002 to 0,004 mm larger than the 'A' track cone bore. This reduces the level of tight fit to facilitate adjustment of the bearing.

DOUBLE ROW BEARINGS
ZWEIREIHIGES KEGELROLLENLAGER
ROULEMENTS A DOUBLE RANGÉE DE ROULEAUX



55
FLANGED CUP (H TYPE)
AUSSENRING MIT BUND (TYP H)
BAGUE EXTERIEURE A COLLERETTE (TYPE H)

| H | J | da | L | R | Weight Gew. Poids kg | † | | * | | Speed rpm Drehzahl U/min Vitesse tr/mn max | Bearing Number Kurzzeichen Symbolisation | |
|------|--------|----|---|------|-------------------------------|-------|------|------|------|--|--|------------------------------|
| | | | | | | daN/μ | | daN | | | Cone Innenring Cône | Cup Aussenring Cuvette |
| | | | | | | Rad. | Axi. | Rad. | Axi. | | | |
| 4,50 | 104,50 | 70 | 7 | 2,00 | 1,825 | 136 | 13 | 3070 | 990 | 6900 | 110055 | / 110100H |
| 4,50 | 101,34 | 70 | 7 | 2,00 | 2,005 | 136 | 13 | 3070 | 990 | 6900 | 110057X | / 110096XH |
| 4,50 | 102,93 | 70 | 7 | 2,00 | 2,005 | 136 | 13 | 3070 | 990 | 6900 | 110057X | / 110098XH |
| 4,50 | 104,50 | 70 | 7 | 2,00 | 2,005 | 136 | 13 | 3070 | 990 | 6900 | 110057X | / 110100H |
| 4,50 | 104,50 | 72 | 7 | 2,00 | 1,900 | 136 | 13 | 3085 | 1020 | 6600 | 113057X | / 113100H |
| 4,50 | 106,10 | 72 | 7 | 2,00 | 1,900 | 136 | 13 | 3085 | 1020 | 6600 | 113057X | / 113101XH |
| 4,76 | 114,76 | 75 | 8 | 2,50 | 2,470 | 156 | 11 | 3815 | 950 | 6200 | 120057X | / 120110H |
| 4,76 | 117,47 | 75 | 8 | 2,50 | 2,470 | 156 | 11 | 3815 | 950 | 6200 | 120057X | / 120112XH |
| 4,50 | 104,50 | 72 | 7 | 2,00 | 1,900 | 136 | 13 | 3085 | 1020 | 6600 | 113060 | / 113100H |
| 4,50 | 106,10 | 72 | 7 | 2,00 | 1,900 | 136 | 13 | 3085 | 1020 | 6600 | 113060 | / 113101XH |
| 4,76 | 114,76 | 75 | 8 | 2,50 | 2,470 | 156 | 11 | 3815 | 950 | 6200 | 120060 | / 120110H |
| 4,76 | 117,47 | 75 | 8 | 2,50 | 2,470 | 156 | 11 | 3815 | 950 | 6200 | 120060 | / 120112XH |
| 5,55 | 125,55 | 84 | 8 | 2,50 | 2,960 | 164 | 12 | 4290 | 1100 | 5700 | 130060 | / 130120H |
| 5,55 | 132,55 | 84 | 8 | 2,50 | 2,960 | 164 | 12 | 4290 | 1100 | 5700 | 130060 | / 130127H |
| 4,50 | 104,50 | 72 | 7 | 2,00 | 1,900 | 136 | 13 | 3085 | 1020 | 6600 | 113060X | / 113100H |
| 4,50 | 106,10 | 72 | 7 | 2,00 | 1,900 | 136 | 13 | 3085 | 1020 | 6600 | 113060X | / 113101XH |
| 4,76 | 114,76 | 75 | 8 | 2,50 | 2,290 | 156 | 11 | 3815 | 950 | 6200 | 120063X | / 120110H |
| 5,55 | 125,55 | 84 | 8 | 2,50 | 2,960 | 164 | 12 | 4290 | 1100 | 5700 | 130063X | / 130120H |
| 5,55 | 132,55 | 84 | 8 | 2,50 | 2,960 | 164 | 12 | 4290 | 1100 | 5700 | 130063X | / 130127H |
| 5,55 | 125,55 | 84 | 8 | 2,50 | 2,960 | 164 | 12 | 4290 | 1100 | 5700 | 130065 | / 130120H |
| 5,55 | 132,55 | 84 | 8 | 2,50 | 2,960 | 164 | 12 | 4290 | 1100 | 5700 | 130065 | / 130127H |
| 5,55 | 132,55 | 84 | 8 | 2,50 | 2,960 | 164 | 12 | 4290 | 1100 | 5700 | 130069X | / 130127H |
| 4,76 | 117,47 | 86 | 8 | 2,50 | 2,085 | 164 | 13 | 3980 | 1045 | 5800 | 124069X | / 124112XH |
| 5,55 | 125,55 | 84 | 8 | 2,50 | 2,710 | 164 | 12 | 4290 | 1100 | 5700 | 130069X | / 130120H |
| 6,35 | 126,35 | 84 | 8 | 3,57 | 2,790 | 216 | 16 | 5550 | 1405 | 5700 | 135069X | / 135120H |
| 4,76 | 117,47 | 86 | 8 | 2,50 | 2,085 | 164 | 13 | 3980 | 1045 | 5800 | 124070 | / 124112XH |
| 5,55 | 125,55 | 84 | 8 | 2,50 | 2,700 | 164 | 12 | 4290 | 1100 | 5700 | 130070 | / 130120H |
| 5,55 | 132,55 | 84 | 8 | 2,50 | 2,960 | 164 | 12 | 4290 | 1100 | 5700 | 130070 | / 130127H |
| 5,55 | 125,55 | 90 | 8 | 2,50 | 2,350 | 140 | 12 | 3520 | 980 | 5500 | 123073X | / 123120H |
| 5,55 | 126,20 | 90 | 8 | 2,50 | 2,350 | 140 | 12 | 3520 | 980 | 5500 | 123073X | / 123120XH |
| 5,55 | 127,00 | 90 | 8 | 2,50 | 2,350 | 140 | 12 | 3520 | 980 | 5500 | 123073X | / 123121XH |
| 5,55 | 129,37 | 90 | 8 | 2,50 | 2,350 | 140 | 12 | 3520 | 980 | 5500 | 123073X | / 123123XH |
| 5,55 | 125,55 | 90 | 8 | 2,50 | 2,250 | 140 | 12 | 3520 | 980 | 5500 | 123075 | / 123120H |
| 5,55 | 126,20 | 90 | 8 | 2,50 | 2,250 | 140 | 12 | 3520 | 980 | 5500 | 123075 | / 123120XH |
| 5,55 | 127,00 | 90 | 8 | 2,50 | 2,250 | 140 | 12 | 3520 | 980 | 5500 | 123075 | / 123121XH |
| 5,55 | 129,37 | 90 | 8 | 2,50 | 2,250 | 140 | 12 | 3520 | 980 | 5500 | 123075 | / 123123XH |
| 5,55 | 132,55 | 92 | 8 | 2,50 | 3,300 | 180 | 15 | 4645 | 1260 | 5300 | 133075 | / 133127H |
| 5,55 | 135,55 | 92 | 8 | 2,50 | 3,300 | 180 | 15 | 4645 | 1260 | 5300 | 133075 | / 133130H |
| 5,55 | 138,90 | 92 | 8 | 2,50 | 3,300 | 180 | 15 | 4645 | 1260 | 5300 | 133075 | / 133133XH |
| 5,55 | 142,08 | 92 | 8 | 2,50 | 3,300 | 180 | 15 | 4645 | 1260 | 5300 | 133075 | / 133136XH |
| 5,55 | 125,55 | 90 | 8 | 2,50 | 2,250 | 140 | 12 | 3520 | 980 | 5500 | 123076X | / 123120H |
| 5,55 | 126,20 | 90 | 8 | 2,50 | 2,250 | 140 | 12 | 3520 | 980 | 5500 | 123076X | / 123120XH |
| 5,55 | 129,37 | 90 | 8 | 2,50 | 2,250 | 140 | 12 | 3520 | 980 | 5500 | 123076X | / 123123XH |
| 5,55 | 132,55 | 92 | 8 | 2,50 | 3,300 | 180 | 15 | 4645 | 1260 | 5300 | 133076X | / 133127H |
| 5,55 | 135,55 | 92 | 8 | 2,50 | 3,300 | 180 | 15 | 4645 | 1260 | 5300 | 133076X | / 133130H |
| 5,55 | 138,90 | 92 | 8 | 2,50 | 3,300 | 180 | 15 | 4645 | 1260 | 5300 | 133076X | / 133133XH |
| 5,55 | 142,08 | 92 | 8 | 2,50 | 3,300 | 180 | 15 | 4645 | 1260 | 5300 | 133076X | / 133136XH |
| 5,55 | 125,55 | 90 | 8 | 2,50 | 2,250 | 140 | 12 | 3520 | 980 | 5500 | 123077X | / 123120H |
| 5,55 | 126,20 | 90 | 8 | 2,50 | 2,250 | 140 | 12 | 3520 | 980 | 5500 | 123077X | / 123120XH |
| 5,55 | 127,00 | 90 | 8 | 2,50 | 2,250 | 140 | 12 | 3520 | 980 | 5500 | 123077X | / 123121XH |

Wichtiger Hinweis: Bei zweireihigen Lagern ist die Bohrung des hinteren Innenrings (Markierung 'B-Laufbahn') 0,002 bis 0,004mm grösser als die Bohrung der 'A'-Laufbahn. Dies erweitert den Sitz der Passung und erleichtert das Einstellen des Lagers.

Note importante: Pour les roulements à double rangée, l'alésage du cône arrière (marqué 'B') est plus grand de 0,002 à 0,004mm que l'alésage du cône marqué 'A'. Ceci réduit le serrage de l'ajustement pour faciliter le montage du roulement.

**FLANGED CUP (H TYPE)
 AUSSENRING MIT BUND (TYP H)
 BAGUE EXTERIEURE A COLLERETTE (TYPE H)**

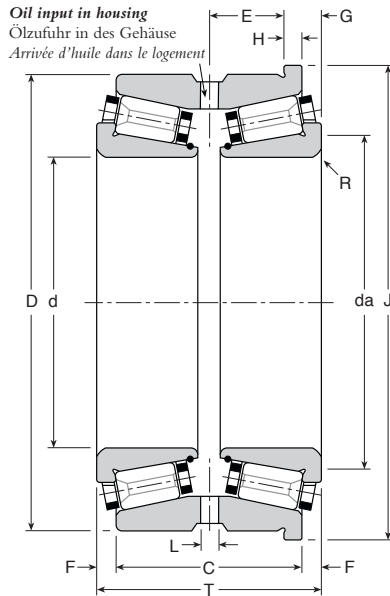

- da - Recommended shaft abutment diameter
 empfohlener Durchmesser des Wellen-Widerlagers
 diamètre recommandé d'épaulement de l'arbre
- L - 6 equally spaced holes (diameter)
 6 Bohrungen am Umfang
 6 trous équidistants
- † - Static Stiffness
 Statische Steifigkeit
 Rigidité statique
- * - Basic Rating 10,000hrs@500rpm
 Belastung 10,000h@500U/min
 Capacité 10,000h@500tr/mn

**Manufacturing Tolerances
 Fertigungstoleranzen
 Tolérances de fabrication**

| | d ≤ 180mm | d > 180mm |
|-------------------|-------------|-------------|
| Bore d | +0,005 0 | +0,010 0 |
| Diameter D | +0,005 0 | +0,010 0 |
| Width G | ±0,25 | ±0,25 |
| Overall width T | ±0,50 | ±0,50 |
| Flange diameter J | 0 -0,10 | 0 -0,10 |
| Flange width H | ±0,05 | ±0,05 |

| d | D | T | C | E | F | G |
|---------|---------|--------|-------|-------|------|-------|
| 77,788 | 123,825 | 64,00 | 49,70 | 19,30 | 7,15 | 12,70 |
| 80,000 | 140,000 | 85,00 | 69,14 | 28,22 | 7,93 | 14,28 |
| 80,962 | 133,350 | 74,00 | 58,12 | 21,12 | 7,94 | 13,50 |
| 82,550 | 133,350 | 74,00 | 58,12 | 21,12 | 7,94 | 13,50 |
| 82,550 | 136,525 | 74,00 | 58,12 | 21,12 | 7,94 | 13,50 |
| 82,550 | 140,000 | 85,00 | 69,14 | 28,22 | 7,93 | 14,28 |
| 84,138 | 133,350 | 74,00 | 58,12 | 21,12 | 7,94 | 13,50 |
| 84,138 | 136,525 | 74,00 | 58,12 | 21,12 | 7,94 | 13,50 |
| 85,000 | 140,000 | 85,00 | 69,14 | 28,22 | 7,93 | 14,28 |
| 85,000 | 170,000 | 106,00 | 89,00 | 37,50 | 8,50 | 15,50 |
| 85,725 | 133,350 | 74,00 | 58,12 | 21,12 | 7,94 | 13,50 |
| 85,725 | 136,525 | 74,00 | 58,12 | 21,12 | 7,94 | 13,50 |
| 88,900 | 133,350 | 74,00 | 58,12 | 21,12 | 7,94 | 13,50 |
| 88,900 | 136,525 | 74,00 | 58,12 | 21,12 | 7,94 | 13,50 |
| 90,000 | 133,350 | 76,00 | 60,12 | 23,71 | 7,94 | 14,29 |
| 90,000 | 150,000 | 75,00 | 62,00 | 25,00 | 6,50 | 12,50 |
| 90,000 | 152,400 | 75,00 | 62,00 | 25,00 | 6,50 | 12,50 |
| 90,000 | 152,400 | 92,00 | 75,80 | 30,90 | 8,10 | 15,10 |
| 90,000 | 158,750 | 75,00 | 62,00 | 25,00 | 6,50 | 12,50 |
| 90,000 | 158,750 | 92,00 | 75,80 | 30,90 | 8,10 | 15,10 |
| 90,000 | 160,000 | 92,00 | 75,80 | 30,90 | 8,10 | 15,10 |
| 90,000 | 161,925 | 92,00 | 75,80 | 30,90 | 8,10 | 15,10 |
| 90,000 | 170,000 | 106,00 | 89,00 | 37,50 | 8,50 | 15,50 |
| 92,075 | 150,000 | 75,00 | 62,00 | 25,00 | 6,50 | 12,50 |
| 92,075 | 152,400 | 75,00 | 62,00 | 25,00 | 6,50 | 12,50 |
| 92,075 | 158,750 | 75,00 | 62,00 | 25,00 | 6,50 | 12,50 |
| 93,663 | 150,000 | 75,00 | 62,00 | 25,00 | 6,50 | 12,50 |
| 93,663 | 152,400 | 75,00 | 62,00 | 25,00 | 6,50 | 12,50 |
| 93,663 | 158,750 | 75,00 | 62,00 | 25,00 | 6,50 | 12,50 |
| 95,000 | 150,000 | 75,00 | 62,00 | 25,00 | 6,50 | 12,50 |
| 95,000 | 152,400 | 75,00 | 62,00 | 25,00 | 6,50 | 12,50 |
| 95,000 | 158,750 | 75,00 | 62,00 | 25,00 | 6,50 | 12,50 |
| 95,000 | 170,000 | 106,00 | 89,00 | 37,50 | 8,50 | 15,50 |
| 97,000 | 150,000 | 75,00 | 62,00 | 25,00 | 6,50 | 12,50 |
| 97,000 | 152,400 | 75,00 | 62,00 | 25,00 | 6,50 | 12,50 |
| 97,000 | 158,750 | 75,00 | 62,00 | 25,00 | 6,50 | 12,50 |
| 98,425 | 152,400 | 92,00 | 75,80 | 30,90 | 8,10 | 15,10 |
| 98,425 | 158,750 | 92,00 | 75,80 | 30,90 | 8,10 | 15,10 |
| 98,425 | 160,000 | 92,00 | 75,80 | 30,90 | 8,10 | 15,10 |
| 98,425 | 161,925 | 92,00 | 75,80 | 30,90 | 8,10 | 15,10 |
| 100,000 | 170,000 | 100,00 | 84,00 | 35,00 | 8,00 | 15,00 |
| 100,000 | 180,000 | 100,00 | 84,00 | 35,00 | 8,00 | 15,00 |
| 100,000 | 180,975 | 100,00 | 84,00 | 35,00 | 8,00 | 15,00 |
| 100,000 | 190,000 | 100,00 | 84,00 | 35,00 | 8,00 | 15,00 |
| 101,600 | 165,100 | 87,00 | 67,96 | 27,63 | 9,52 | 15,87 |
| 101,600 | 170,000 | 100,00 | 84,00 | 35,00 | 8,00 | 15,00 |
| 101,600 | 180,000 | 100,00 | 84,00 | 35,00 | 8,00 | 15,00 |
| 101,600 | 180,975 | 100,00 | 84,00 | 35,00 | 8,00 | 15,00 |
| 101,600 | 190,000 | 100,00 | 84,00 | 35,00 | 8,00 | 15,00 |
| 105,000 | 170,000 | 100,00 | 84,00 | 35,00 | 8,00 | 15,00 |

Important note: For double row bearings the bore of the rear cone (marked 'B' track) is 0,002 to 0,004 mm larger than the 'A' track cone bore. This reduces the level of tight fit to facilitate adjustment of the bearing.

DOUBLE ROW BEARINGS
ZWEIREIHIGES KEGELROLLENLAGER
ROULEMENTS A DOUBLE RANGÉE DE ROULEAUX

FLANGED CUP (H TYPE)
AUSSENRING MIT BUND (TYP H)
BAGUE EXTERIEURE A COLLERETTE (TYPE H)

| H | J | da | L | R | Weight Gew. Poids kg | † | | * | | Speed rpm Drehzahl U/min Vitesse tr/mn max | Bearing Number Kurzzeichen Symbolisation | |
|------|--------|-----|----|------|-------------------------------|-------|------|-------|------|--|--|------------------------------|
| | | | | | | daN/μ | | daN | | | Cone Innenring Cône | Cup Aussenring Cuvette |
| | | | | | | Rad. | Axi. | Rad. | Axi. | | | |
| 5,55 | 129,37 | 90 | 8 | 2,50 | 2,250 | 140 | 12 | 3520 | 980 | 5500 | 123077X | / 123123XH |
| 6,35 | 146,34 | 100 | 8 | 3,00 | 4,545 | 200 | 15 | 5685 | 1410 | 4900 | 140080 | / 140140H |
| 5,56 | 138,88 | 102 | 8 | 2,50 | 2,250 | 198 | 19 | 4650 | 1425 | 4900 | 126080X | / 126133XH |
| 5,56 | 138,88 | 102 | 8 | 2,50 | 2,250 | 198 | 19 | 4650 | 1425 | 4900 | 126082X | / 126133XH |
| 5,56 | 142,06 | 102 | 8 | 2,50 | 2,250 | 198 | 19 | 4650 | 1425 | 4900 | 126082X | / 126136XH |
| 6,35 | 146,34 | 100 | 8 | 3,00 | 4,345 | 200 | 15 | 5685 | 1410 | 4900 | 140082X | / 140140H |
| 5,56 | 138,88 | 102 | 8 | 2,50 | 2,400 | 198 | 19 | 4650 | 1425 | 4900 | 126084X | / 126133XH |
| 5,56 | 142,06 | 102 | 8 | 2,50 | 2,400 | 198 | 19 | 4650 | 1425 | 4900 | 126084X | / 126136XH |
| 6,35 | 146,34 | 100 | 8 | 3,00 | 4,145 | 200 | 15 | 5685 | 1410 | 4900 | 140085 | / 140140H |
| 7,00 | 177,00 | 114 | 8 | 3,50 | 8,545 | 246 | 18 | 10640 | 2630 | 4200 | 210085 | / 210170H |
| 5,56 | 138,88 | 102 | 8 | 2,50 | 2,400 | 198 | 19 | 4650 | 1425 | 4900 | 126085X | / 126133XH |
| 5,56 | 142,06 | 102 | 8 | 2,50 | 2,400 | 198 | 19 | 4650 | 1425 | 4900 | 126085X | / 126136XH |
| 5,56 | 138,88 | 102 | 8 | 2,50 | 2,400 | 198 | 19 | 4650 | 1425 | 4900 | 126088X | / 126133XH |
| 5,56 | 142,06 | 102 | 8 | 2,50 | 2,400 | 198 | 19 | 4650 | 1425 | 4900 | 126088X | / 126136XH |
| 6,35 | 139,70 | 105 | 8 | 2,50 | 4,000 | 204 | 19 | 4275 | 1315 | 4800 | 117090 | / 117133XH |
| 6,00 | 156,00 | 110 | 8 | 2,50 | 4,745 | 206 | 20 | 5115 | 1630 | 4400 | 131090 | / 131150H |
| 6,00 | 158,40 | 110 | 8 | 2,50 | 4,745 | 206 | 20 | 5115 | 1630 | 4400 | 131090 | / 131152XH |
| 7,00 | 159,40 | 114 | 9 | 2,50 | 5,150 | 230 | 17 | 7275 | 1785 | 4300 | 160090 | / 160152XH |
| 6,00 | 164,75 | 110 | 8 | 2,50 | 4,745 | 206 | 20 | 5115 | 1630 | 4400 | 131090 | / 131158XH |
| 7,00 | 164,75 | 114 | 9 | 2,50 | 5,150 | 230 | 17 | 7275 | 1785 | 4300 | 160090 | / 160158XH |
| 7,00 | 167,00 | 114 | 9 | 2,50 | 5,150 | 230 | 17 | 7275 | 1785 | 4300 | 160090 | / 160160H |
| 7,00 | 168,90 | 114 | 9 | 2,50 | 5,150 | 230 | 17 | 7275 | 1785 | 4300 | 160090 | / 160161XH |
| 7,00 | 177,00 | 114 | 8 | 3,50 | 8,545 | 246 | 18 | 10640 | 2630 | 4200 | 210090 | / 210170H |
| 6,00 | 156,00 | 110 | 8 | 2,50 | 4,745 | 206 | 20 | 5115 | 1630 | 4400 | 131092X | / 131150H |
| 6,00 | 158,40 | 110 | 8 | 2,50 | 4,745 | 206 | 20 | 5115 | 1630 | 4400 | 131092X | / 131152XH |
| 6,00 | 164,75 | 110 | 8 | 2,50 | 4,745 | 206 | 20 | 5115 | 1630 | 4400 | 131092X | / 131158XH |
| 6,00 | 156,00 | 110 | 8 | 2,50 | 4,745 | 206 | 20 | 5115 | 1630 | 4400 | 131093X | / 131150H |
| 6,00 | 158,40 | 110 | 8 | 2,50 | 4,745 | 206 | 20 | 5115 | 1630 | 4400 | 131093X | / 131152XH |
| 6,00 | 164,75 | 110 | 8 | 2,50 | 4,745 | 206 | 20 | 5115 | 1630 | 4400 | 131093X | / 131158XH |
| 6,00 | 156,00 | 110 | 8 | 2,50 | 4,745 | 206 | 20 | 5115 | 1630 | 4400 | 131095 | / 131150H |
| 6,00 | 158,40 | 110 | 8 | 2,50 | 4,625 | 206 | 20 | 5115 | 1630 | 4400 | 131095 | / 131152XH |
| 6,00 | 164,75 | 110 | 8 | 2,50 | 4,745 | 206 | 20 | 5115 | 1630 | 4400 | 131095 | / 131158XH |
| 7,00 | 177,00 | 114 | 8 | 2,50 | 8,545 | 246 | 18 | 10640 | 2630 | 4200 | 210095 | / 210170H |
| 6,00 | 156,00 | 110 | 8 | 2,50 | 4,745 | 206 | 20 | 5115 | 1630 | 4400 | 131097 | / 131150H |
| 6,00 | 158,40 | 110 | 8 | 2,50 | 4,465 | 206 | 20 | 5115 | 1630 | 4400 | 131097 | / 131152XH |
| 6,00 | 164,75 | 110 | 8 | 2,50 | 4,745 | 206 | 20 | 5115 | 1630 | 4400 | 131097 | / 131158XH |
| 7,00 | 159,40 | 114 | 9 | 2,50 | 5,150 | 230 | 17 | 7275 | 1785 | 4300 | 160098X | / 160152XH |
| 7,00 | 164,75 | 114 | 9 | 2,50 | 5,150 | 230 | 17 | 7275 | 1785 | 4300 | 160098X | / 160158XH |
| 7,00 | 167,00 | 114 | 9 | 2,50 | 5,150 | 230 | 17 | 7275 | 1785 | 4300 | 160098X | / 160160H |
| 7,00 | 168,90 | 114 | 9 | 2,50 | 5,150 | 230 | 17 | 7275 | 1785 | 4300 | 160098X | / 160161XH |
| 7,00 | 177,00 | 125 | 10 | 2,50 | 9,520 | 254 | 19 | 9100 | 2240 | 3900 | 180100 | / 180170H |
| 7,00 | 187,00 | 125 | 10 | 2,50 | 9,420 | 254 | 19 | 9100 | 2240 | 3900 | 180100 | / 180180H |
| 7,00 | 188,00 | 125 | 10 | 2,50 | 9,520 | 254 | 19 | 9100 | 2240 | 3900 | 180100 | / 180180XH |
| 7,00 | 197,00 | 125 | 10 | 2,50 | 11,120 | 254 | 19 | 9100 | 2240 | 3900 | 180100 | / 180190H |
| 6,35 | 171,45 | 128 | 8 | 3,00 | 9,400 | 252 | 23 | 6595 | 1990 | 3900 | 141101X | / 141165XH |
| 7,00 | 177,00 | 125 | 10 | 2,50 | 9,520 | 254 | 19 | 9100 | 2240 | 3900 | 180101X | / 180170H |
| 7,00 | 188,00 | 125 | 10 | 2,50 | 9,520 | 254 | 19 | 9100 | 2240 | 3900 | 180101X | / 180180H |
| 7,00 | 188,00 | 125 | 10 | 2,50 | 9,520 | 254 | 19 | 9100 | 2240 | 3900 | 180101X | / 180180XH |
| 7,00 | 197,00 | 125 | 10 | 2,50 | 11,080 | 254 | 19 | 9100 | 2240 | 3900 | 180101X | / 180190H |
| 7,00 | 177,00 | 125 | 10 | 2,50 | 9,520 | 254 | 19 | 9100 | 2240 | 3900 | 180105 | / 180170H |

Wichtiger Hinweis: Bei zweireihigen Lagern ist die Bohrung des hinteren Innenrings (Markierung 'B-Laufbahn') 0,002 bis 0,004mm grösser als die Bohrung der 'A'-Laufbahn. Dies erweitert den Sitz der Passung und erleichtert das Einstellen des Lagers.

Note importante: Pour les roulements à double rangée, l'alésage du cône arrière (marqué 'B') est plus grand de 0,002 à 0,004mm que l'alésage du cône marqué 'A'. Ceci réduit le serrage de l'ajustement pour faciliter le montage du roulement.

**FLANGED CUP (H TYPE)
 AUSSENRING MIT BUND (TYP H)
 BAGUE EXTERIEURE A COLLERETTE (TYPE H)**

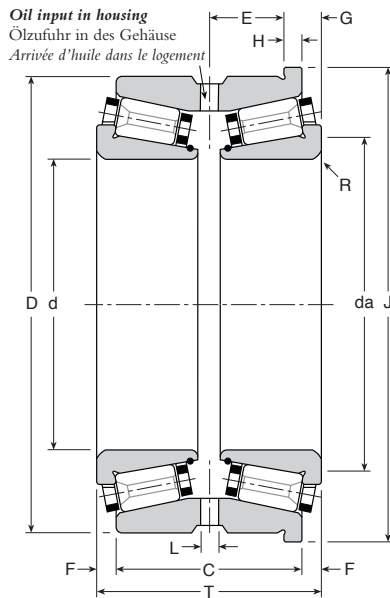

- da - Recommended shaft abutment diameter
 empfohlener Durchmesser des Wellen-Widerlagers
 diamètre recommandé d'épaulement de l'arbre
- L - 6 equally spaced holes (diameter)
 6 Bohrungen am Umfang
 6 trous équidistants
- † - Static Stiffness
 Statische Steifigkeit
 Rigidité statique
- * - Basic Rating 10,000hrs@500rpm
 Belastung 10,000h@500U/min
 Capacité 10,000h@500tr/mn

**Manufacturing Tolerances
 Fertigungstoleranzen
 Tolérances de fabrication**

| | d ≤ 180mm | d > 180mm |
|-------------------|-------------|-------------|
| Bore d | +0,005 0 | +0,010 0 |
| Diameter D | +0,005 0 | +0,010 0 |
| Width G | ±0,25 | ±0,25 |
| Overall width T | ±0,50 | ±0,50 |
| Flange diameter J | 0 -0,10 | 0 -0,10 |
| Flange width H | ±0,05 | ±0,05 |

| d | D | T | C | E | F | G |
|---------|---------|--------|--------|-------|-------|-------|
| 105,000 | 180,000 | 100,00 | 84,00 | 35,00 | 8,00 | 15,00 |
| 105,000 | 180,975 | 100,00 | 84,00 | 35,00 | 8,00 | 15,00 |
| 105,000 | 190,000 | 100,00 | 84,00 | 35,00 | 8,00 | 15,00 |
| 107,950 | 165,100 | 87,00 | 67,96 | 27,63 | 9,52 | 15,87 |
| 111,125 | 180,975 | 108,00 | 82,60 | 33,36 | 12,70 | 20,64 |
| 111,125 | 190,000 | 108,00 | 82,60 | 33,36 | 12,70 | 20,64 |
| 111,125 | 190,500 | 108,00 | 82,60 | 33,36 | 12,70 | 20,64 |
| 111,125 | 200,025 | 108,00 | 82,60 | 33,36 | 12,70 | 20,64 |
| 115,000 | 165,000 | 65,00 | 55,00 | 23,00 | 5,00 | 9,50 |
| 115,000 | 180,975 | 108,00 | 82,60 | 33,36 | 12,70 | 20,64 |
| 115,000 | 190,000 | 108,00 | 82,60 | 33,36 | 12,70 | 20,64 |
| 115,000 | 190,500 | 108,00 | 82,60 | 33,36 | 12,70 | 20,64 |
| 115,000 | 200,025 | 108,00 | 82,60 | 33,36 | 12,70 | 20,64 |
| 118,000 | 180,975 | 108,00 | 82,60 | 33,36 | 12,70 | 20,64 |
| 118,000 | 190,000 | 108,00 | 82,60 | 33,36 | 12,70 | 20,64 |
| 118,000 | 190,500 | 108,00 | 82,60 | 33,36 | 12,70 | 20,64 |
| 118,000 | 200,025 | 108,00 | 82,60 | 33,36 | 12,70 | 20,64 |
| 120,000 | 165,000 | 65,00 | 55,00 | 23,00 | 5,00 | 9,50 |
| 120,000 | 190,000 | 108,00 | 82,60 | 33,36 | 12,70 | 20,64 |
| 120,000 | 190,500 | 108,00 | 82,60 | 33,36 | 12,70 | 20,64 |
| 120,000 | 199,000 | 108,00 | 82,60 | 33,36 | 12,70 | 20,64 |
| 120,000 | 200,000 | 108,00 | 82,60 | 33,36 | 12,70 | 20,64 |
| 127,000 | 196,850 | 101,60 | 85,74 | 35,72 | 7,93 | 15,08 |
| 127,000 | 200,025 | 101,60 | 85,74 | 35,72 | 7,93 | 15,08 |
| 127,000 | 215,000 | 110,00 | 92,00 | 38,00 | 9,00 | 17,00 |
| 127,000 | 215,900 | 110,00 | 92,00 | 38,00 | 9,00 | 17,00 |
| 133,350 | 196,850 | 101,60 | 85,74 | 35,72 | 7,93 | 15,08 |
| 133,350 | 196,850 | 92,60 | 76,74 | 28,22 | 7,93 | 18,08 |
| 133,350 | 200,025 | 101,60 | 85,74 | 35,72 | 7,93 | 15,08 |
| 133,350 | 215,000 | 110,00 | 92,00 | 38,00 | 9,00 | 17,00 |
| 133,350 | 215,900 | 110,00 | 92,00 | 38,00 | 9,00 | 17,00 |
| 136,525 | 215,000 | 110,00 | 92,00 | 38,00 | 9,00 | 17,00 |
| 136,525 | 215,900 | 110,00 | 92,00 | 38,00 | 9,00 | 17,00 |
| 139,700 | 215,000 | 110,00 | 92,00 | 38,00 | 9,00 | 17,00 |
| 139,700 | 215,900 | 110,00 | 92,00 | 38,00 | 9,00 | 17,00 |
| 139,700 | 241,300 | 126,00 | 104,00 | 42,00 | 11,00 | 21,00 |
| 140,000 | 200,000 | 92,30 | 78,00 | 33,45 | 7,15 | 12,70 |
| 140,000 | 200,025 | 92,30 | 78,00 | 33,45 | 7,15 | 12,70 |
| 142,875 | 200,000 | 92,30 | 78,00 | 33,45 | 7,15 | 12,70 |
| 142,875 | 200,025 | 92,30 | 78,00 | 33,45 | 7,15 | 12,70 |
| 145,000 | 241,300 | 126,00 | 104,00 | 42,00 | 11,00 | 21,00 |
| 145,000 | 256,000 | 110,00 | 92,00 | 38,00 | 9,00 | 17,00 |
| 149,225 | 241,300 | 126,00 | 104,00 | 42,00 | 11,00 | 21,00 |
| 150,000 | 210,000 | 92,00 | 76,00 | 31,50 | 8,00 | 14,50 |
| 152,400 | 222,250 | 105,00 | 81,20 | 32,66 | 11,90 | 19,84 |
| 152,400 | 254,000 | 155,00 | 116,90 | 47,34 | 19,05 | 30,16 |
| 152,400 | 266,700 | 155,00 | 116,90 | 47,34 | 19,05 | 30,16 |
| 155,575 | 254,000 | 155,00 | 116,90 | 47,34 | 19,05 | 30,16 |
| 155,575 | 266,700 | 155,00 | 116,90 | 47,34 | 19,05 | 30,16 |
| 156,000 | 235,000 | 110,00 | 92,00 | 38,00 | 9,00 | 17,00 |

Important note: For double row bearings the bore of the rear cone (marked 'B' track) is 0,002 to 0,004 mm larger than the 'A' track cone bore. This reduces the level of tight fit to facilitate adjustment of the bearing.

DOUBLE ROW BEARINGS
ZWEIREIHIGES KEGELROLLENLAGER
ROULEMENTS A DOUBLE RANGÉE DE ROULEAUX

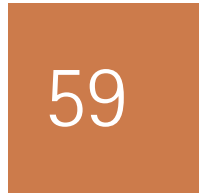

59
FLANGED CUP (H TYPE)
AUSSENRING MIT BUND (TYP H)
BAGUE EXTERIEURE A COLLERETTE (TYPE H)

| H | J | da | L | R | Weight Gew. Poids kg | † | | * | | Speed rpm Drehzahl U/min Vitesse tr/mn max | Bearing Number Kurzzeichen Symbolisation | |
|-------|--------|-----|----|------|-------------------------------|-------|------|-------|------|--|--|------------------------------|
| | | | | | | daN/μ | | daN | | | Cone Innenring Cône | Cup Aussenring Cuvette |
| | | | | | | Rad. | Axi. | Rad. | Axi. | | | |
| 7,00 | 188,00 | 125 | 10 | 2,50 | 9,520 | 254 | 19 | 9100 | 2240 | 3900 | 180105 | / 180180H |
| 7,00 | 188,00 | 125 | 10 | 2,50 | 9,060 | 254 | 19 | 9100 | 2240 | 3900 | 180105 | / 180180XH |
| 7,00 | 197,00 | 125 | 10 | 2,50 | 10,620 | 254 | 19 | 9100 | 2240 | 3900 | 180105 | / 180190H |
| 6,35 | 171,45 | 128 | 8 | 3,00 | 9,400 | 252 | 23 | 6595 | 1990 | 3900 | 141107X | / 141165XHS |
| 7,94 | 188,90 | 136 | 10 | 3,50 | 8,600 | 266 | 22 | 9425 | 2495 | 3600 | 181111X | / 181180XH |
| 7,94 | 198,00 | 136 | 10 | 3,50 | 10,100 | 266 | 22 | 9425 | 2495 | 3600 | 181111X | / 181190H |
| 7,94 | 198,43 | 136 | 10 | 3,50 | 10,400 | 266 | 22 | 9425 | 2495 | 3600 | 181111X | / 181190XH |
| 7,94 | 208,00 | 136 | 10 | 3,50 | 8,600 | 266 | 22 | 9425 | 2495 | 3600 | 181111X | / 181200XH |
| 4,50 | 169,50 | 136 | 9 | 2,50 | 3,450 | 278 | 22 | 4920 | 1205 | 3900 | 105115 | / 105165H |
| 7,94 | 188,90 | 136 | 10 | 3,50 | 8,100 | 266 | 22 | 9425 | 2495 | 3600 | 181115 | / 181180XH |
| 7,94 | 198,00 | 136 | 10 | 3,50 | 9,600 | 266 | 22 | 9425 | 2495 | 3600 | 181115 | / 181190H |
| 7,94 | 198,43 | 136 | 10 | 3,50 | 9,900 | 266 | 22 | 9425 | 2495 | 3600 | 181115 | / 181190XH |
| 7,94 | 208,00 | 136 | 10 | 3,50 | 8,600 | 266 | 22 | 9425 | 2495 | 3600 | 181115 | / 181200XH |
| 7,94 | 188,90 | 136 | 10 | 3,50 | 7,680 | 266 | 22 | 9425 | 2495 | 3600 | 181118 | / 181180XH |
| 7,94 | 198,00 | 136 | 10 | 3,50 | 9,180 | 266 | 22 | 9425 | 2495 | 3600 | 181118 | / 181190H |
| 7,94 | 198,43 | 136 | 10 | 3,50 | 9,480 | 266 | 22 | 9425 | 2495 | 3600 | 181118 | / 181190XH |
| 7,94 | 208,00 | 136 | 10 | 3,50 | 8,600 | 266 | 22 | 9425 | 2495 | 3600 | 181118 | / 181200XH |
| 4,50 | 169,50 | 136 | 9 | 2,50 | 3,450 | 278 | 22 | 4920 | 1205 | 3900 | 105120 | / 105165H |
| 7,94 | 198,00 | 142 | 10 | 3,50 | 8,800 | 280 | 23 | 9750 | 2695 | 3500 | 184120 | / 184190H |
| 7,94 | 198,50 | 142 | 10 | 3,50 | 8,800 | 280 | 23 | 9750 | 2695 | 3500 | 184120 | / 184190XH |
| 7,94 | 207,00 | 142 | 10 | 3,50 | 8,800 | 280 | 23 | 9750 | 2695 | 3500 | 184120 | / 184199H |
| 7,94 | 208,00 | 142 | 10 | 3,50 | 8,800 | 280 | 23 | 9750 | 2695 | 3500 | 184120 | / 184200H |
| 7,15 | 204,00 | 152 | 10 | 3,00 | 9,200 | 298 | 28 | 8770 | 2735 | 3400 | 164127X | / 164196XH |
| 7,15 | 207,18 | 152 | 10 | 3,00 | 9,200 | 298 | 28 | 8770 | 2735 | 3400 | 164127X | / 164200XH |
| 8,00 | 224,00 | 155 | 10 | 2,50 | 13,900 | 304 | 23 | 12065 | 2965 | 3100 | 200127X | / 200215H |
| 8,00 | 224,00 | 155 | 10 | 2,50 | 13,900 | 304 | 23 | 12065 | 2965 | 3100 | 200127X | / 200215XH |
| 7,15 | 204,00 | 152 | 10 | 3,00 | 9,200 | 298 | 28 | 8770 | 2735 | 3400 | 164133X | / 164196XH |
| 10,15 | 204,00 | 152 | 10 | 3,00 | 8,500 | 298 | 28 | 8770 | 2735 | 3400 | 164133X | / 164196XHS |
| 7,15 | 207,18 | 152 | 10 | 3,00 | 9,200 | 298 | 28 | 8770 | 2735 | 3400 | 164133X | / 164200XH |
| 8,00 | 224,00 | 155 | 10 | 2,50 | 13,900 | 304 | 23 | 12065 | 2965 | 3100 | 200133X | / 200215H |
| 8,00 | 224,00 | 155 | 10 | 2,50 | 12,850 | 304 | 23 | 12065 | 2965 | 3100 | 200133X | / 200215XH |
| 8,00 | 224,00 | 155 | 10 | 2,50 | 13,900 | 304 | 23 | 12065 | 2965 | 3100 | 200136X | / 200215H |
| 8,00 | 224,00 | 155 | 10 | 2,50 | 12,330 | 304 | 23 | 12065 | 2965 | 3100 | 200136X | / 200215XH |
| 8,00 | 224,00 | 155 | 10 | 2,50 | 13,900 | 304 | 23 | 12065 | 2965 | 3100 | 200139X | / 200215H |
| 8,00 | 224,00 | 155 | 10 | 2,50 | 13,900 | 304 | 23 | 12065 | 2965 | 3100 | 200139X | / 200215XH |
| 10,00 | 251,00 | 170 | 12 | 2,50 | 20,485 | 342 | 26 | 16410 | 4060 | 2900 | 240139X | / 240241XH |
| 5,55 | 205,50 | 158 | 10 | 3,00 | 10,000 | 310 | 31 | 9010 | 2940 | 3100 | 161140 | / 161200HS |
| 5,55 | 205,50 | 158 | 10 | 3,00 | 10,000 | 310 | 31 | 9010 | 2940 | 3100 | 161140 | / 161200XHS |
| 5,55 | 205,50 | 158 | 10 | 3,00 | 10,000 | 310 | 31 | 9010 | 2940 | 3100 | 161142X | / 161200HS |
| 5,55 | 205,50 | 158 | 10 | 3,00 | 10,000 | 310 | 31 | 9010 | 2940 | 3100 | 161142X | / 161200XHS |
| 10,00 | 251,00 | 170 | 12 | 2,50 | 19,405 | 342 | 26 | 16410 | 4060 | 2900 | 240145 | / 240241XH |
| 8,00 | 243,00 | 182 | 12 | 3,00 | 14,870 | 346 | 30 | 13365 | 3605 | 2700 | 203145 | / 203256H |
| 10,00 | 251,00 | 170 | 12 | 2,50 | 20,485 | 342 | 26 | 16410 | 4060 | 2900 | 240149X | / 240241XH |
| 6,50 | 216,50 | 170 | 10 | 3,00 | 10,200 | 320 | 34 | 9260 | 3185 | 3000 | 163150 | / 163210H |
| 7,94 | 230,19 | 174 | 12 | 3,50 | 11,150 | 330 | 32 | 11050 | 3575 | 3000 | 183152X | / 183222XH |
| 11,11 | 265,10 | 182 | 12 | 7,00 | 25,600 | 382 | 28 | 21450 | 5280 | 2600 | 281152X | / 281254XH |
| 11,11 | 277,80 | 182 | 12 | 7,00 | 25,600 | 382 | 28 | 21450 | 5280 | 2600 | 281152X | / 281266XH |
| 11,11 | 265,10 | 182 | 12 | 7,00 | 25,600 | 382 | 28 | 21450 | 5280 | 2600 | 281155X | / 281254XH |
| 11,11 | 277,80 | 182 | 12 | 7,00 | 25,600 | 382 | 28 | 21450 | 5280 | 2600 | 281155X | / 281266XH |
| 8,00 | 243,00 | 182 | 12 | 3,00 | 14,870 | 346 | 30 | 13365 | 3605 | 2700 | 203156 | / 203235H |

Wichtiger Hinweis: Bei zweireihigen Lagern ist die Bohrung des hinteren Innenrings (Markierung 'B-Laufbahn') 0,002 bis 0,004mm grösser als die Bohrung der 'A'-Laufbahn. Dies erweitert den Sitz der Passung und erleichtert das Einstellen des Lagers.

Note importante: Pour les roulements à double rangée, l'alésage du cône arrière (marqué 'B') est plus grand de 0,002 à 0,004mm que l'alésage du cône marqué 'A'. Ceci réduit le serrage de l'ajustement pour faciliter le montage du roulement.

**FLANGED CUP (H TYPE)
 AUSSENRING MIT BUND (TYP H)
 BAGUE EXTERIEURE A COLLERETTE (TYPE H)**

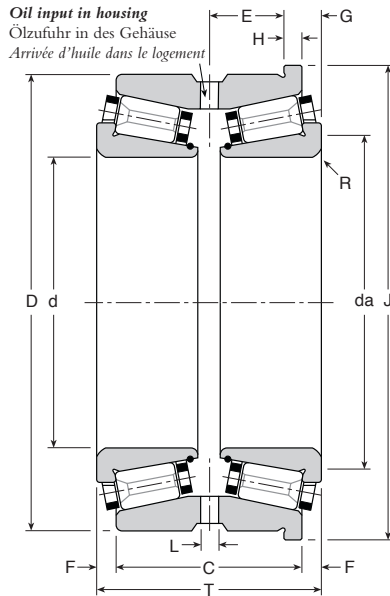

- da - Recommended shaft abutment diameter
 empfohlener Durchmesser des Wellen-Widerlagers
 diamètre recommandé d'épaulement de l'arbre
- L - 6 equally spaced holes (diameter)
 6 Bohrungen am Umfang
 6 trous équidistants
- † - Static Stiffness
 Statische Steifigkeit
 Rigidité statique
- * - Basic Rating 10,000hrs@500rpm
 Belastung 10,000h@500U/min
 Capacité 10,000h@500tr/mn

**Manufacturing Tolerances
 Fertigungstoleranzen
 Tolérances de fabrication**

| | d ≤ 180mm | d > 180mm |
|-------------------|-------------|-------------|
| Bore d | +0,005 0 | +0,010 0 |
| Diameter D | +0,005 0 | +0,010 0 |
| Width G | ±0,25 | ±0,25 |
| Overall width T | ±0,50 | ±0,50 |
| Flange diameter J | 0 -0,10 | 0 -0,10 |
| Flange width H | ±0,05 | ±0,05 |

| d | D | T | C | E | F | G |
|---------|---------|--------|--------|-------|-------|-------|
| 165,100 | 254,000 | 108,00 | 88,96 | 37,34 | 9,52 | 16,66 |
| 170,000 | 254,000 | 108,00 | 88,96 | 37,34 | 9,52 | 16,66 |
| 177,800 | 227,013 | 75,00 | 63,48 | 25,74 | 5,76 | 11,76 |
| 177,800 | 254,000 | 108,00 | 88,96 | 37,34 | 9,52 | 16,66 |
| 177,800 | 288,925 | 154,00 | 122,25 | 50,01 | 15,88 | 26,99 |
| 185,000 | 258,000 | 110,00 | 90,00 | 37,00 | 10,00 | 18,00 |
| 190,000 | 266,700 | 113,18 | 94,14 | 39,93 | 9,52 | 16,66 |
| 190,500 | 266,700 | 113,18 | 94,14 | 39,93 | 9,52 | 16,66 |
| 190,500 | 282,575 | 120,00 | 91,42 | 36,19 | 14,29 | 23,81 |
| 190,500 | 290,000 | 114,00 | 96,00 | 40,00 | 9,00 | 17,00 |
| 203,200 | 310,000 | 156,00 | 121,08 | 49,43 | 17,46 | 28,88 |
| 203,200 | 317,500 | 156,00 | 121,08 | 49,43 | 17,46 | 28,88 |
| 210,000 | 290,000 | 114,00 | 96,00 | 40,00 | 9,00 | 17,00 |
| 210,000 | 310,000 | 156,00 | 121,08 | 49,43 | 17,46 | 28,88 |
| 210,000 | 317,500 | 156,00 | 121,08 | 49,43 | 17,46 | 28,88 |
| 215,900 | 355,600 | 166,00 | 124,72 | 51,25 | 20,64 | 31,75 |
| 228,600 | 355,600 | 166,00 | 124,72 | 51,25 | 20,64 | 31,75 |
| 230,000 | 327,025 | 122,00 | 90,24 | 35,60 | 15,88 | 25,40 |
| 230,000 | 330,000 | 122,00 | 90,24 | 35,60 | 15,88 | 25,40 |
| 234,950 | 327,025 | 122,00 | 90,24 | 35,60 | 15,88 | 25,40 |
| 234,950 | 330,000 | 122,00 | 90,24 | 35,60 | 15,88 | 25,40 |
| 234,950 | 355,600 | 166,00 | 124,72 | 51,25 | 20,64 | 31,75 |
| 254,000 | 400,050 | 146,00 | 114,24 | 44,42 | 15,88 | 28,58 |
| 275,000 | 406,400 | 176,00 | 140,00 | 55,00 | 18,00 | 33,00 |
| 280,194 | 406,400 | 176,00 | 140,00 | 55,00 | 18,00 | 33,00 |
| 330,200 | 482,600 | 200,00 | 157,73 | 64,98 | 20,64 | 35,02 |
| 338,138 | 419,100 | 94,00 | 79,00 | 32,50 | 7,50 | 14,50 |
| 355,600 | 482,600 | 145,00 | 100,55 | 39,17 | 22,23 | 33,34 |
| 381,000 | 508,000 | 187,00 | 147,00 | 59,50 | 20,00 | 34,00 |
| 406,400 | 549,275 | 200,00 | 152,36 | 61,90 | 23,82 | 38,10 |
| 431,800 | 533,400 | 123,00 | 100,78 | 42,45 | 11,11 | 19,05 |
| 457,200 | 596,900 | 187,00 | 147,00 | 59,50 | 20,00 | 34,00 |
| 506,000 | 636,000 | 187,00 | 147,00 | 59,50 | 20,00 | 34,00 |

Important note: For double row bearings the bore of the rear cone (marked 'B' track) is 0,002 to 0,004 mm larger than the 'A' track cone bore. This reduces the level of tight fit to facilitate adjustment of the bearing.

DOUBLE ROW BEARINGS
ZWEIREIHIGES KEGELROLLENLAGER
ROULEMENTS A DOUBLE RANGÉE DE ROULEAUX



61
FLANGED CUP (H TYPE)
AUSSENRING MIT BUND (TYP H)
BAGUE EXTERIEURE A COLLERETTE (TYPE H)

| H | J | da | L | R | Weight Gew. Poids kg | ‡ | | * | | Speed rpm Drehzahl U/min Vitesse tr/mn max | Bearing Number Kurzzzeichen Symbolisation | |
|-------|--------|-----|----|------|-------------------------------|-------|------|-------|-------|--|---|------------------------------|
| | | | | | | daN/μ | | daN | | | Cone Innenring Cône | Cup Aussenring Cuvette |
| | | | | | | Rad. | Axi. | Rad. | Axi. | | | |
| 7,14 | 261,14 | 200 | 10 | 3,00 | 15,000 | 382 | 43 | 12170 | 4460 | 2600 | 186165X | / 186254XH |
| 7,14 | 261,14 | 200 | 10 | 3,00 | 15,000 | 382 | 43 | 12170 | 4460 | 2600 | 186170 | / 186254XH |
| 6,00 | 233,00 | 192 | 10 | 1,50 | 6,150 | 360 | 30 | 6825 | 1770 | 2700 | 115177X | / 115227XH |
| 7,14 | 261,14 | 200 | 10 | 3,00 | 15,000 | 382 | 43 | 12170 | 4460 | 2600 | 186177X | / 186254XH |
| 11,11 | 300,03 | 210 | 12 | 7,00 | 32,600 | 440 | 36 | 23725 | 6580 | 2300 | 280177X | / 280288XH |
| 8,00 | 266,00 | 210 | 10 | 3,00 | 12,300 | 394 | 47 | 12430 | 4760 | 2500 | 187185 | / 187258H |
| 7,14 | 273,80 | 215 | 10 | 3,00 | 15,500 | 402 | 40 | 14685 | 4695 | 2400 | 204190 | / 204266XH |
| 7,14 | 273,80 | 215 | 10 | 3,00 | 15,500 | 402 | 40 | 14685 | 4695 | 2400 | 204190X | / 204266XH |
| 9,52 | 292,10 | 217 | 12 | 2,50 | 20,000 | 336 | 31 | 15925 | 4645 | 2300 | 242190X | / 242282XH |
| 8,00 | 298,00 | 238 | 12 | 3,50 | 17,300 | 428 | 47 | 15400 | 5360 | 2200 | 206190X | / 206290H |
| 11,11 | 321,11 | 240 | 12 | 4,40 | 32,800 | 480 | 44 | 25185 | 7715 | 2100 | 283203X | / 283310H |
| 11,11 | 328,61 | 240 | 12 | 4,40 | 36,300 | 480 | 44 | 25185 | 7715 | 2100 | 283203X | / 283317XH |
| 8,00 | 298,00 | 238 | 12 | 3,50 | 17,300 | 428 | 47 | 15400 | 5360 | 2200 | 206210 | / 206290H |
| 11,11 | 321,11 | 240 | 12 | 4,40 | 32,000 | 480 | 44 | 25185 | 7715 | 2100 | 283210 | / 283310H |
| 11,11 | 328,61 | 240 | 12 | 4,40 | 35,500 | 480 | 44 | 25185 | 7715 | 2100 | 283210 | / 283317XH |
| 11,11 | 366,62 | 270 | 12 | 7,00 | 51,000 | 536 | 56 | 27625 | 9295 | 1900 | 284215X | / 284355XH |
| 11,11 | 366,62 | 270 | 12 | 7,00 | 51,000 | 536 | 56 | 27625 | 9295 | 1900 | 284228X | / 284355XH |
| 9,52 | 336,55 | 265 | 12 | 6,00 | 23,200 | 416 | 44 | 18035 | 6460 | 1900 | 244230 | / 244327XH |
| 9,52 | 339,52 | 265 | 12 | 6,00 | 27,350 | 416 | 44 | 18035 | 6460 | 1900 | 244230 | / 244330H |
| 9,52 | 336,55 | 265 | 12 | 6,00 | 21,000 | 416 | 44 | 18035 | 6460 | 1900 | 244234X | / 244327XH |
| 9,52 | 339,52 | 265 | 12 | 6,00 | 27,000 | 416 | 44 | 18035 | 6460 | 1900 | 244234X | / 244330H |
| 11,11 | 366,62 | 270 | 12 | 7,00 | 48,430 | 536 | 56 | 27625 | 9295 | 1900 | 284234X | / 284355XH |
| 12,70 | 412,75 | 300 | 12 | 3,00 | 55,500 | 358 | 28 | 27625 | 7230 | 1700 | 382254X | / 382400XH |
| 15,00 | 421,40 | 324 | 12 | 6,00 | 67,600 | 680 | 56 | 39000 | 10400 | 1600 | 320275 | / 320406XH |
| 15,00 | 421,40 | 324 | 12 | 6,00 | 64,840 | 680 | 56 | 39000 | 10400 | 1600 | 320280X | / 320406XH |
| 14,38 | 496,98 | 370 | 12 | 6,00 | 105,000 | 792 | 78 | 53625 | 17140 | 1400 | 380330X | / 380482XH |
| 7,00 | 426,10 | 362 | 12 | 3,00 | 30,900 | 534 | 55 | 12215 | 3815 | 1500 | 152338X | / 152419XH |
| 11,11 | 493,71 | 395 | 12 | 7,00 | 58,700 | 570 | 86 | 27625 | 13240 | 1400 | 282355X | / 282482XH |
| 14,00 | 522,00 | 424 | 12 | 7,00 | 80,000 | 834 | 71 | 41890 | 11340 | 1300 | 303381X | / 303508XH |
| 14,28 | 563,55 | 456 | 12 | 7,00 | 98,250 | 882 | 100 | 46635 | 16950 | 1200 | 323406XS | / 323549XHS |
| 7,94 | 541,34 | 465 | 12 | 5,00 | 45,000 | 642 | 71 | 24130 | 8365 | 1200 | 232431X | / 232533XH |
| 14,00 | 610,90 | 505 | 12 | 7,00 | 95,000 | 982 | 99 | 47285 | 14950 | 1100 | 300457X | / 300596XH |
| 14,00 | 650,00 | 555 | 12 | 7,00 | 116,000 | 1044 | 115 | 49325 | 17060 | 1000 | 307506 | / 307636H |

Wichtiger Hinweis: Bei zweireihigen Lagern ist die Bohrung des hinteren Innenrings (Markierung 'B-Laufbahn') 0,002 bis 0,004mm grösser als die Bohrung der 'A'-Laufbahn. Dies erweitert den Sitz der Passung und erleichtert das Einstellen des Lagers.

Note importante: Pour les roulements à double rangée, l'alésage du cône arrière (marqué 'B') est plus grand de 0,002 à 0,004mm que l'alésage du cône marqué 'A'. Ceci réduit le serrage de l'ajustement pour faciliter le montage du roulement.