

# Nylon Tread Load Runners - Concentric & Eccentric - Inch Sizes

Cost-effective performance in applications requiring a non-metallic outer face.

- Seals out contamination
- Non-sparking
- Non-marking

Applications:

- Racking & Storage Retrieval Systems
- Food Processing
- Postal Systems
- Medical Equipment

## Concentric Stud Style

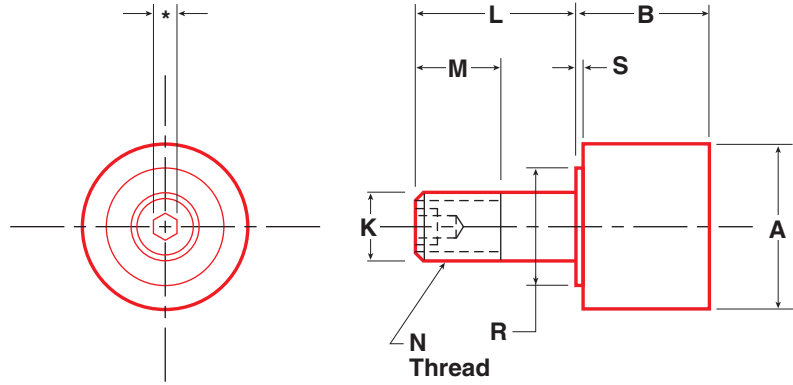

### CONCENTRIC STUD STYLE

Part No.	Item No.	A	B	K	L	M	N	R	S
		Roller Dia	Roller Width	Stud Dia	Stud Length	Thread Length	Thread	Shoulder Dia	Shoulder Length
		+0.000 -0.001		+0.000 -0.001					
<b>PLRN-1</b>	97749	1.000	0.781	0.437	1.000	0.500	7/16-20	0.500	0.031
<b>PLRN-1-1/4</b>	97750	1.250	0.844	0.500	1.250	0.625	1/2-20	0.625	0.031
<b>PLRN-1-1/2</b>	97751	1.500	1.187	0.625	1.500	0.750	5/8-18	0.750	0.062
<b>PLRN-2</b>	97752	2.000	1.687	0.875	2.000	1.125	7/8-14	1.000	0.062
<b>PLRN-2-1/2</b>	97753	2.500	1.687	1.000	2.250	1.500	1-14	1.250	0.062

### ECCENTRIC STUD STYLE

Part No.	Item No.	A	B	K	L	M	N	R	S	T	U	W
		Roller Dia	Roller Width	Stud Dia	Stud Length	Thread Length	Thread	Shoulder Dia	Shoulder Length	Eccentric Dia	Eccentric Length	Eccentricity
		+0.000 -0.001								+0.001 -0.001	+0.000 -0.010	
<b>PLRNE-1</b>	97891	1.000	0.781	0.437	1.000	0.500	7/16-20	0.750	0.031	0.625	0.500	0.030
<b>PLRNE-1-1/4</b>	97892	1.250	0.844	0.500	1.250	0.625	1/2-20	0.812	0.031	0.687	0.625	0.030
<b>PLRNE-1-1/2</b>	97893	1.500	1.187	0.625	1.500	0.770	5/8-18	1.125	0.062	0.875	0.730	0.030
<b>PLRNE-2</b>	97894	2.000	1.687	0.875	2.000	1.020	7/8-14	1.500	0.062	1.187	0.980	0.030
<b>PLRNE-2-1/2</b>	97895	2.500	1.687	1.000	2.250	1.145	1-14	1.687	0.062	1.375	1.105	0.030

Nylon assemblies provided with jam nut and lock washers.

\*For stud hex socket size, see page 85.

## Eccentric Stud Style

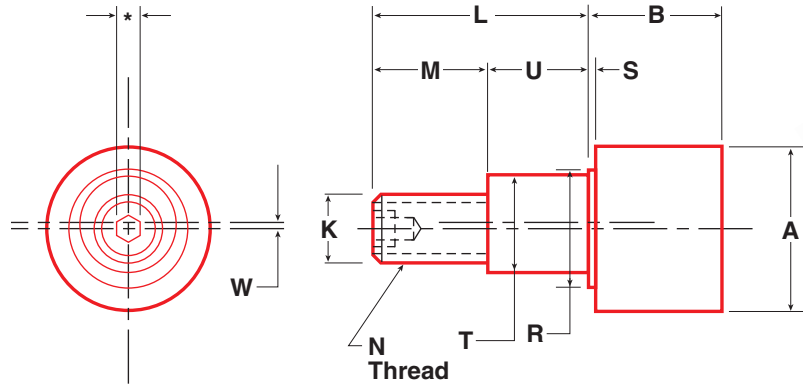

## CONCENTRIC STUD STYLE

Rec. Mtg. Hole Size	Mounting Member Thickness		Bearing Capacity, Radial Load (lbs)			Bearing Capacity, Static Thrust (lbs)	Retaining Ring Capacity (lbs)	Tread Capacity (lbs)	Approx Weight (lbs)	Part No.
			3000 hrs L10 life @ 100 RPM	500 hrs L10 life @ 33 1/3 RPM	Static Limit					
+0.001 -0.000	Max	Min								
0.438	0.625	0.500	240	630	230	140	280	30	0.2	<b>PLRN-1</b>
0.501	0.750	0.625	520	1350	600	370	470	40	0.25	<b>PLRN-1-1/4</b>
0.626	1.000	0.750	1050	2760	1100	680	470	60	0.5	<b>PLRN-1-1/2</b>
0.876	1.250	0.875	1460	3830	1620	1000	910	120	1.1	<b>PLRN-2</b>
1.001	1.250	0.750	1980	5190	2270	1400	1340	130	1.6	<b>PLRN-2-1-2</b>

## ECCENTRIC STUD STYLE

Rec. Mtg. Hole Size	Mounting Member Thickness		Bearing Capacity Radial Load (lbs)			Bearing Static Thrust Capacity (lbs)	Retaining Ring Capacity (lbs)	Tread Capacity (lbs)	Approx Weight (lbs)	Part No.
			3000 hrs L10 life @ 100 RPM	500 hrs L10 life @ 33-1/3 RPM	Static Limit					
+0.001 -0.000	Max	Min								
0.627	0.625	0.500	240	630	230	140	280	30	0.2	<b>PLRNE-1</b>
0.689	0.750	0.625	520	1350	600	370	470	40	0.3	<b>PLRNE-1-1/4</b>
0.877	0.875	0.750	1050	2760	1100	680	470	60	1.1	<b>PLRNE-1-1/2</b>
1.189	1.125	1.000	1460	3830	1620	1000	910	120	1.4	<b>PLRNE-2</b>
1.377	1.250	1.125	1980	5190	2270	1400	1340	130	1.9	<b>PLRNE-2-1/2</b>

LOAD CAPACITIES ARE BASED ON UNIFORM AND STEADY LOADING.